

TAKING BUSINESS TO A WHOLE NEW LEVEL

RERA REGISTRATION NO. : PR/GJ/AHMEDABAD/AHMADABAD CITY/AUDA/CAA02030/160318



701, Astron Tech Park, ISKCON Circle, S. G. Highway, Ahmedabad 15
Phone : 079 26861337, 079 40026060



FOR INQUIRY CONTACT ON : +91 90818 15500, +91 90818 18844

Notes: •The brochure is for restricted private circulation only and is not to be considered as a legal document with obligations for specific performance. It is meant for the purpose of conceptual presentation only. •The dimensions shown in the brochure are approximate and may change slightly without causing any material adverse effect to the purchaser. •All the architectural and interior images in the brochure, are merely simulated interpretations using computer graphics to enhance the customer understanding and are not factual images. • The colour and general appearance of the flooring and wall tiles, sanitary ware and fittings, walls, ceilings, windows, doors, internal roads, trees, shrubbery etc. shown in the simulated computer graphics images are taken from the available object libraries for the purpose of presentation and the prospective purchasers of the property are advised to refer to the construction specifications mentioned in the brochure. Additional amenities and/or utilities not mentioned or shown in the brochure but may be required as per the law, should be deemed to be forming part of the project by the purchaser. •Furniture shown in the simulated images do not form part of the sale of any property by the developer.



Scan this Barcode
on your smart phone
to visit our website.



KRISH CUBICAL
ABSOLUTE CORPORATE



LOOKING FOR A PERFECT CORPORATE WORK SPACE ?

More often than not, being popular and successful is all about being at the right place, at the right time. Welcome to Krish Cubical, the heart of corporate development in Ahmedabad.

An office-space conceived with a vision to put you on the fast-track of prosperity, it is a wonderful place to work, shop and relax. Krish Cubical offers you a rendezvous with the opportunity to own a superbly-located working space.



KRISH CUBICAL
ABSOLUTE CORPORATE

HERE IS THE PERFECT CORPORATE WORK SPACE.

TAKING AESTHETICS TO A WHOLE NEW LEVEL

A magnificent landmark nestling in the city of Ahmedabad, Krish Cubical aims to bring about the needed change in the corporate arena. Designed with supreme luxury and conveniences, it seamlessly blends contemporary architecture with the finest aesthetics.

Savaliya Group envisions providing a rich and unique experience to its patrons. We aim to build a distinguished corporate realm, where you can work in peace, swathed within the world of luxury.





VERO MODA
adidas
Lee
Reebok
MUFTI
Vanheusen
Being human
Spykar
Zara
Arrow
Jack & Jones
Hilfner
GAS



TAKING DESIGN TO A WHOLE NEW LEVEL

ABOUT THE GROUP



With an odyssey that started 29 years ago, we have a growth story that awaits your presence. Don't just see it, feel it with Krish Cubical, the most sought-after corporate address in town.

KRISH CUBICAL

Savaliya Group and Real Estate understands the dynamic nature of designing. Working intricately on the entire lifecycle of Krish Cubical, we have curated an expansive office-space in one of India's most prosperous cities.

When an employee spends 40 hours a week in a building, we understand that it should not be dull. Office premises matter the most when it comes to creating a good work environment. We present you an office-space that emits harmony and is surrounded with a sense of vitality.

SPECIAL FEATURES & AMENITIES

TAKING LEISURE TO A WHOLE NEW LEVEL

- A lavish commercial space of 45 meter height situated near by SG Highway
- Ground + 13 storey to make it a commercial hub
- Double height arcade with air-conditioned entrance foyer that makes the walk through attractive
- Multi-purpose business conference room and cafeteria
- 12 high Speed Elevators (4 Elevators in Each Block)
- Hi-tech safety with 24 X 7 security systems
- Unique Elevation
- Walking distance to proposed metro station
- 5-level parking (3 basements + 1 stack + 1 ground floor)
- Banks, hospitals, shopping malls and hotels nearby
- Round-the-clock water supply
- Beautiful lush green landscape





GROUND FLOOR PLAN

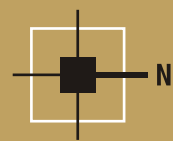

TYPICAL FLOOR PLAN



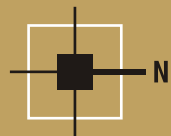

GROUND FLOOR PLAN

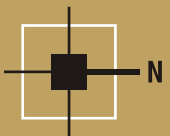
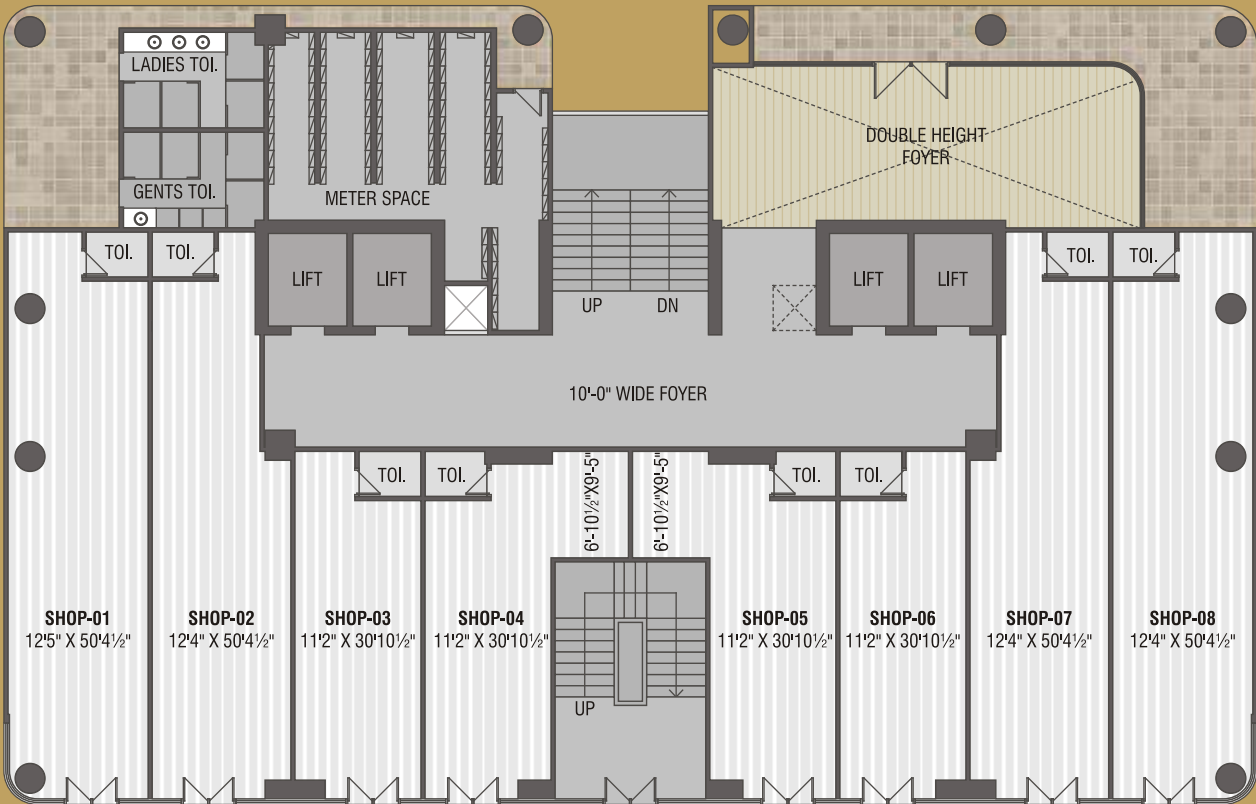

TYPICAL FLOOR PLAN

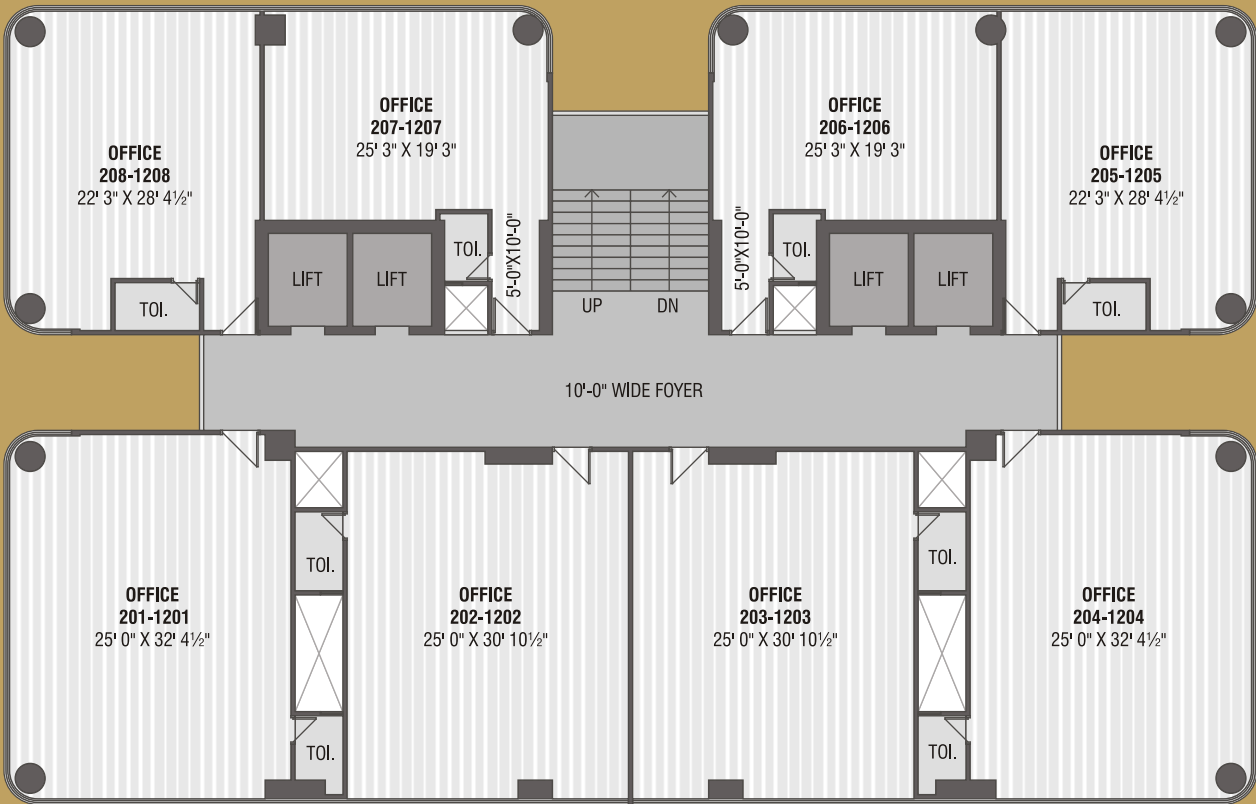

BLOCK A

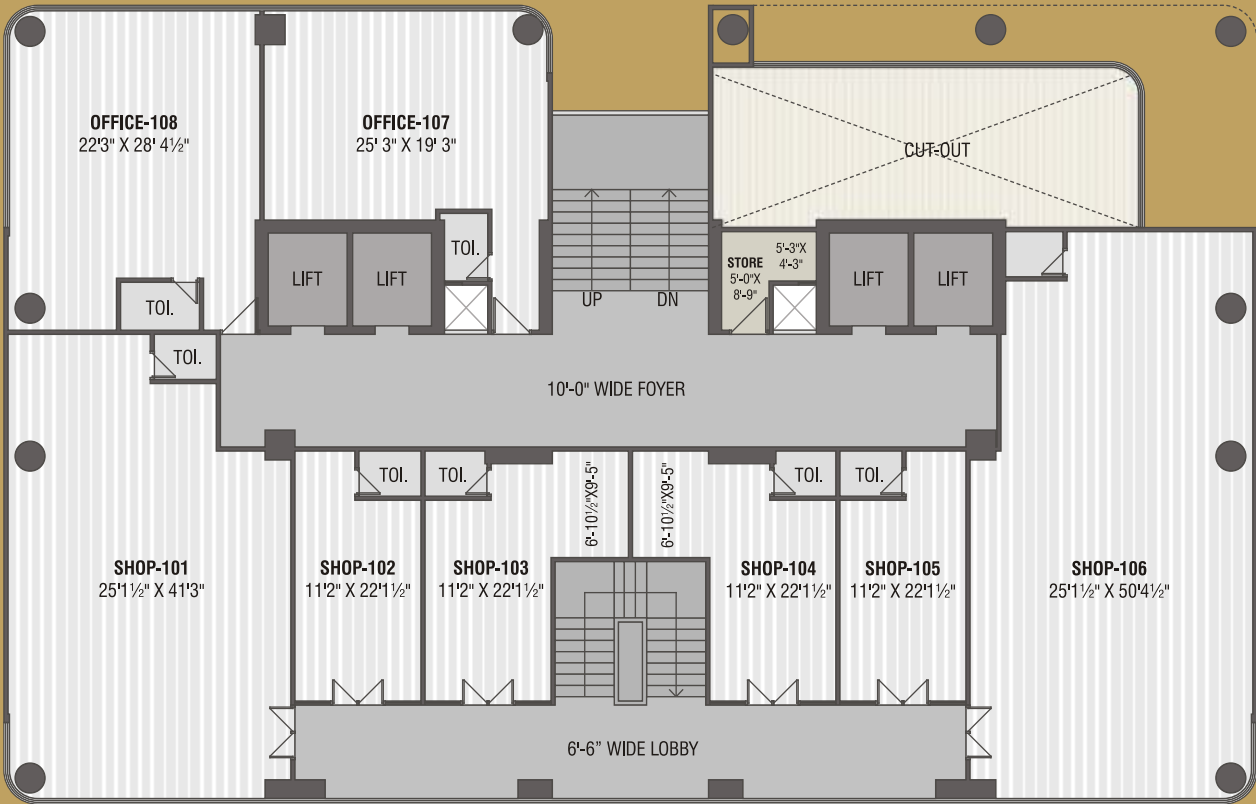

FIRST FLOOR PLAN





GROUND FLOOR PLAN

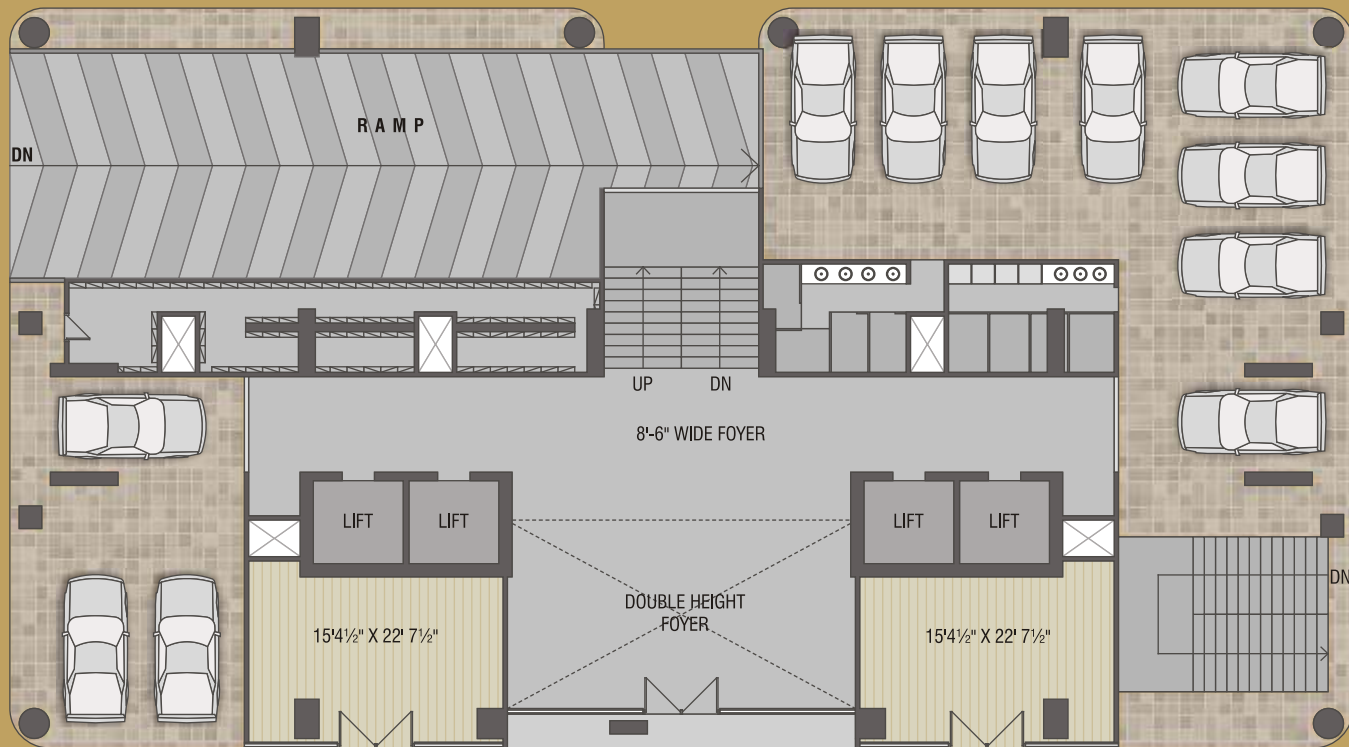

TYPICAL FLOOR PLAN

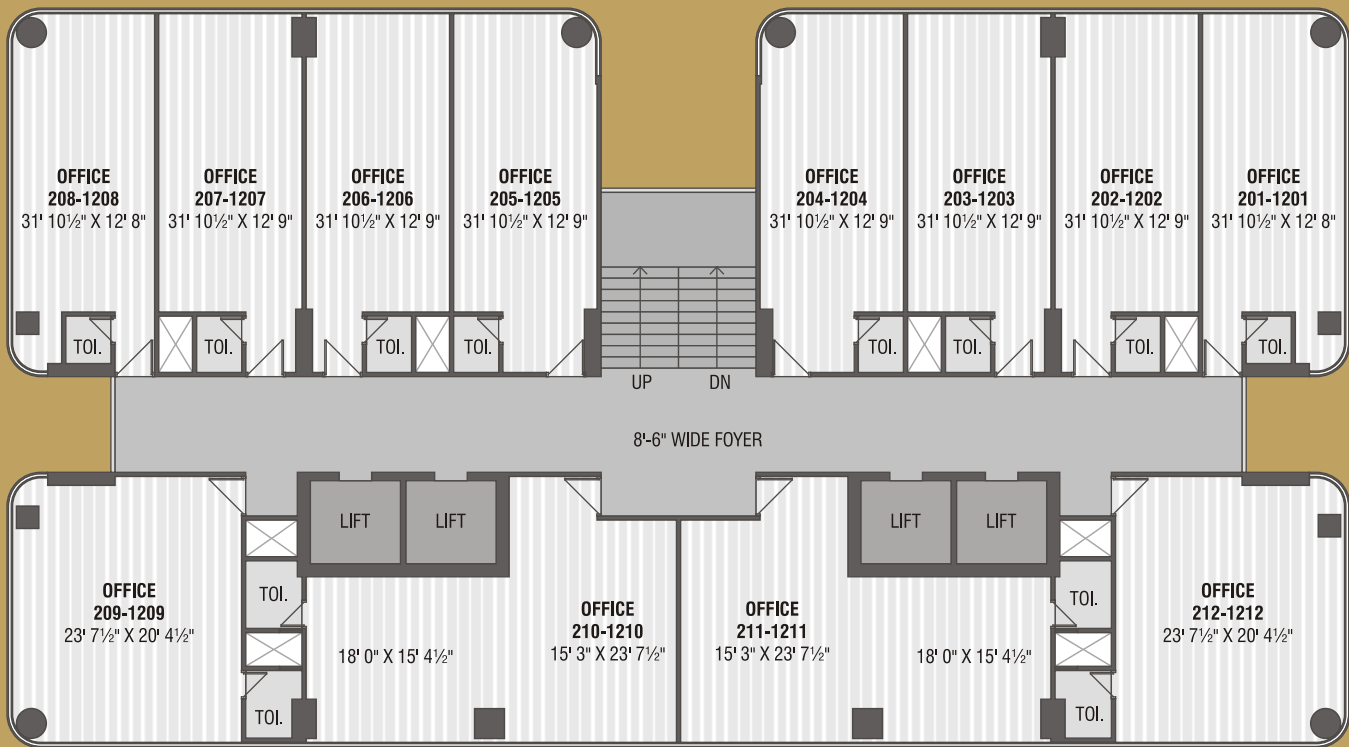

BLOCK B

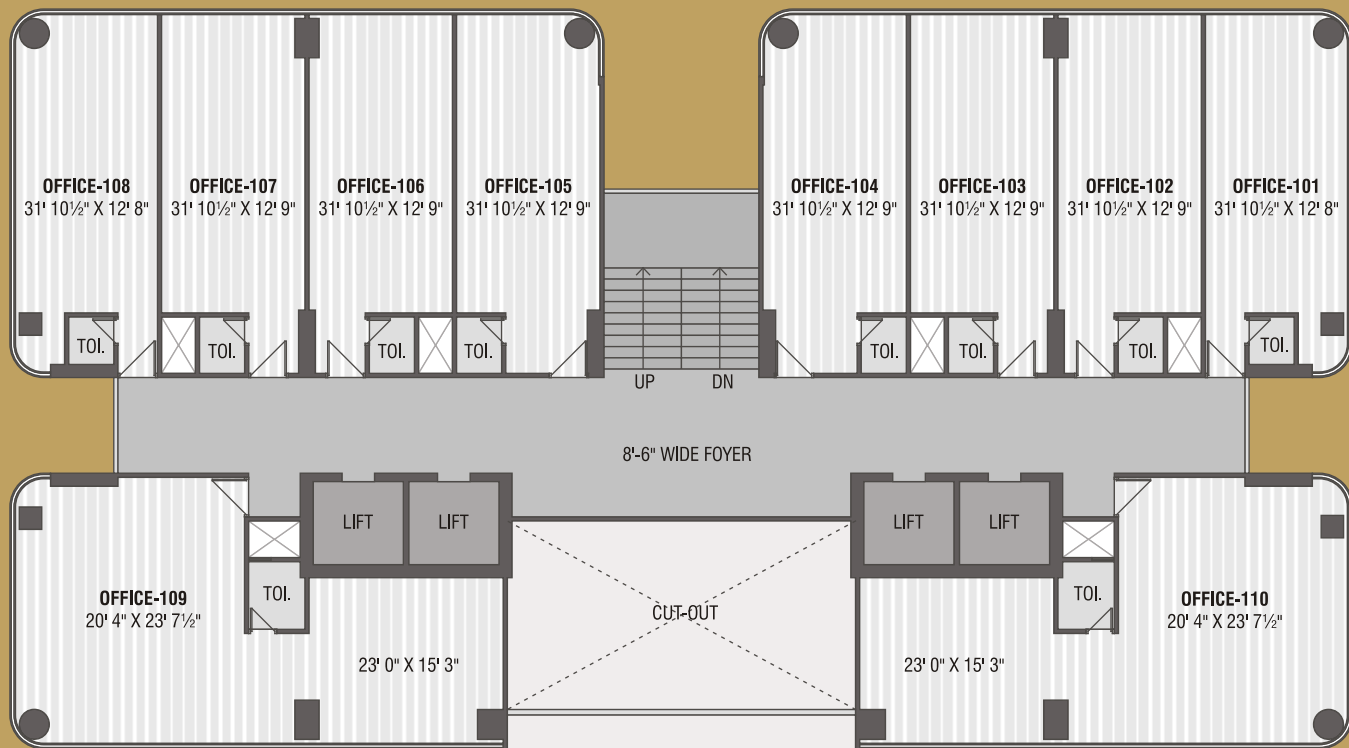

FIRST FLOOR PLAN



13TH FLOOR PLAN

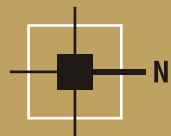

GROUND FLOOR PLAN

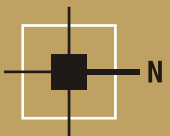
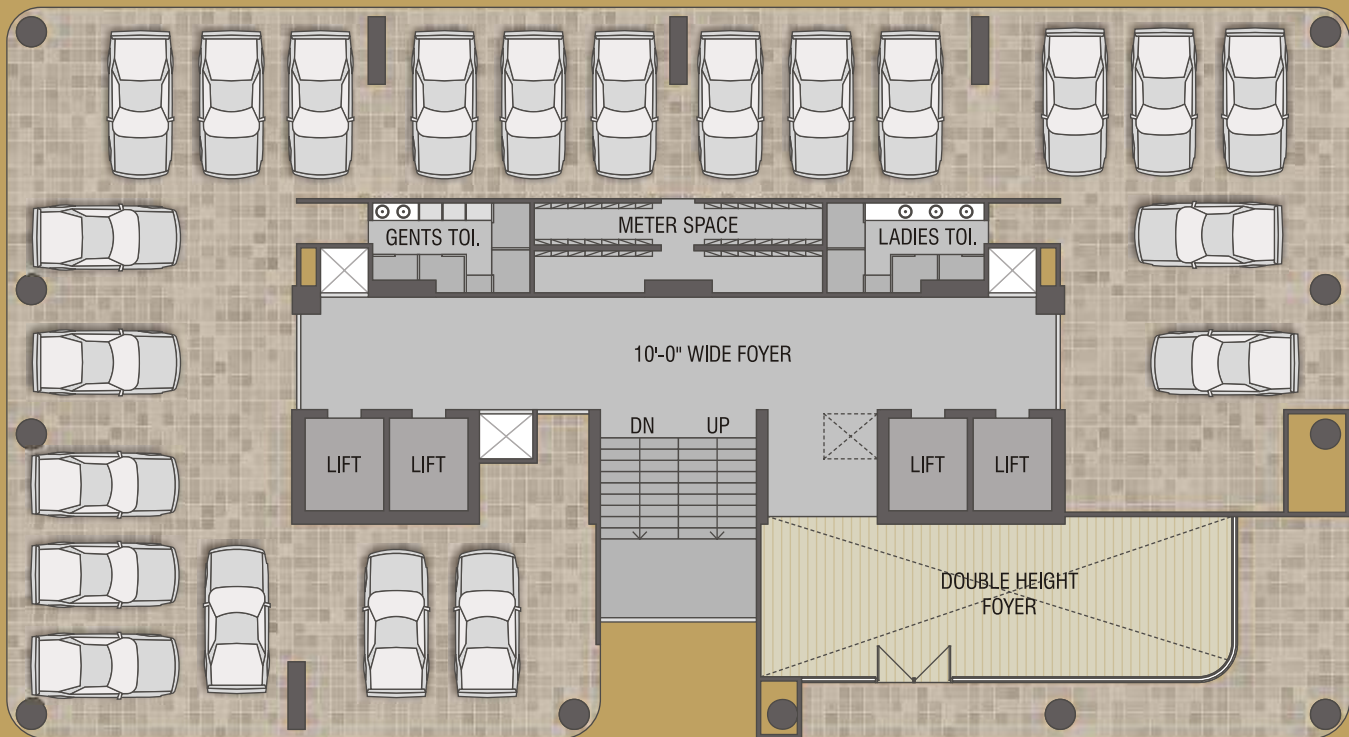

TYPICAL FLOOR PLAN

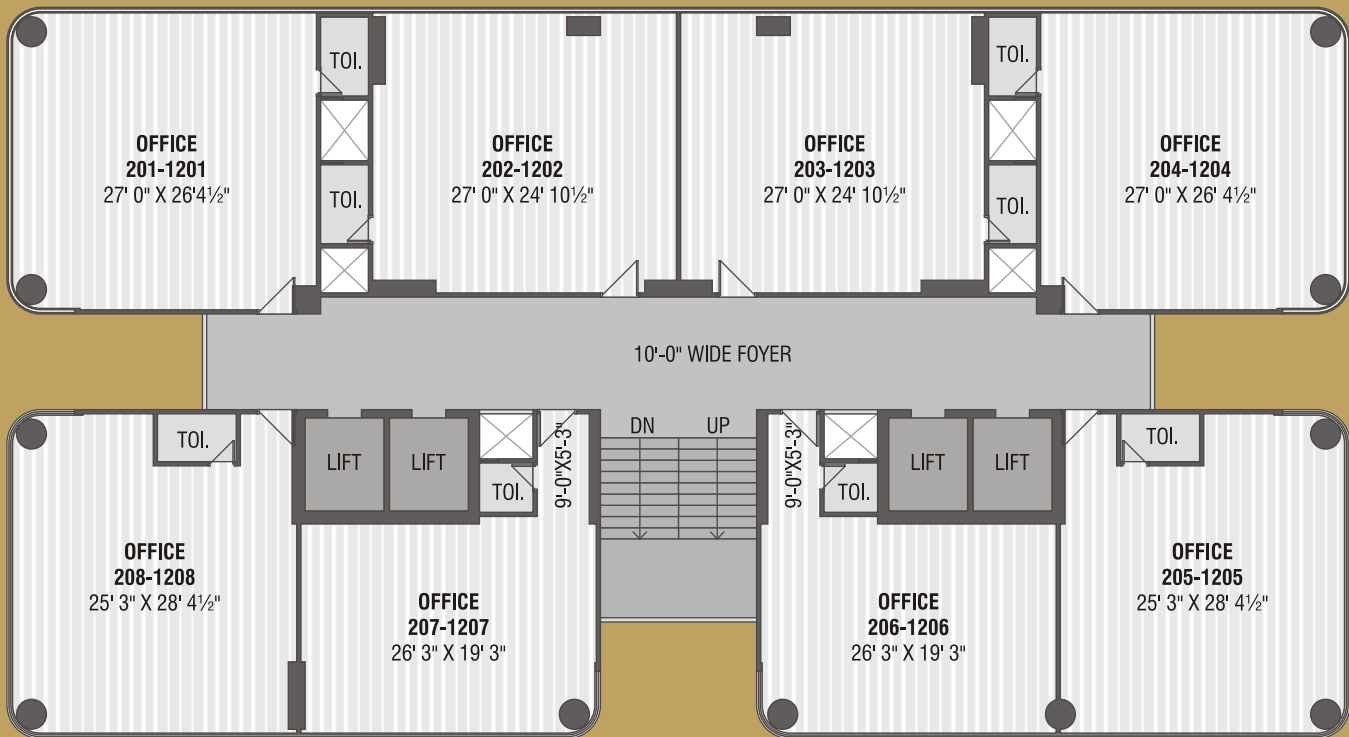

BLOCK C

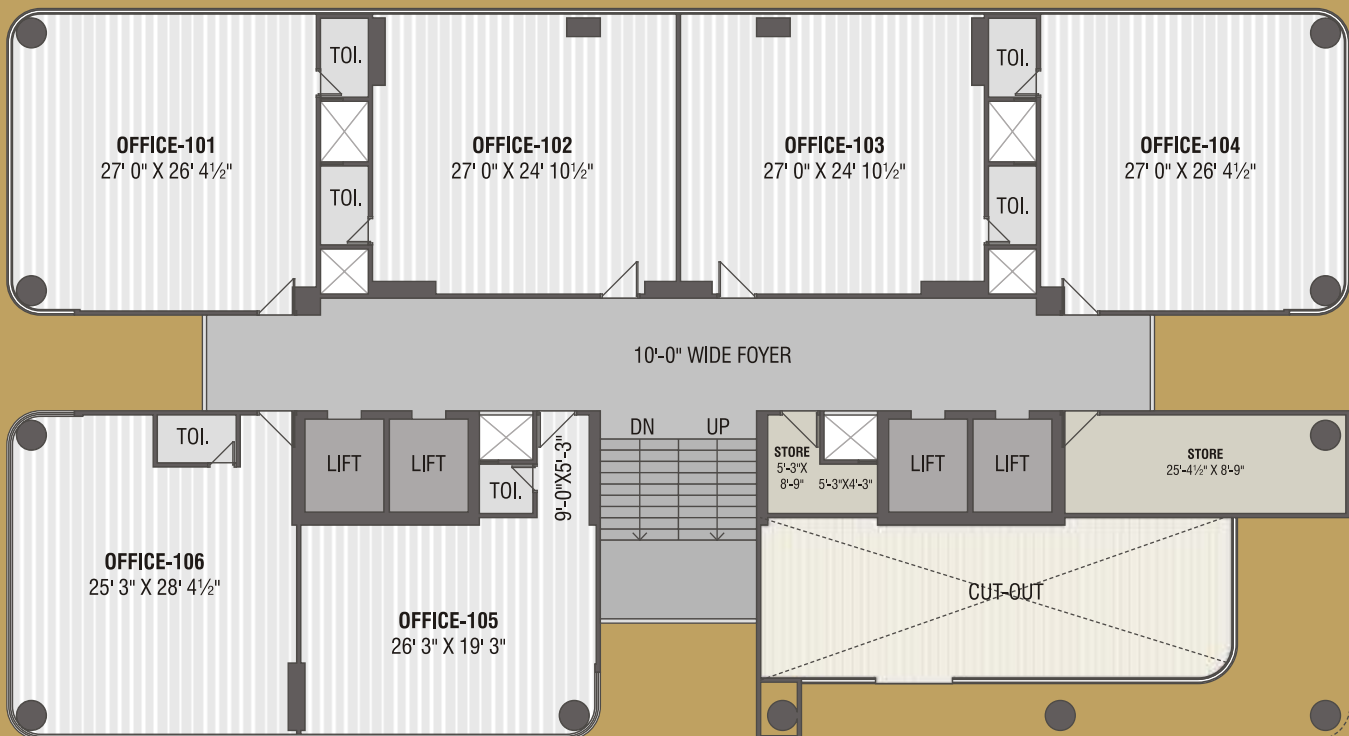

FIRST FLOOR PLAN

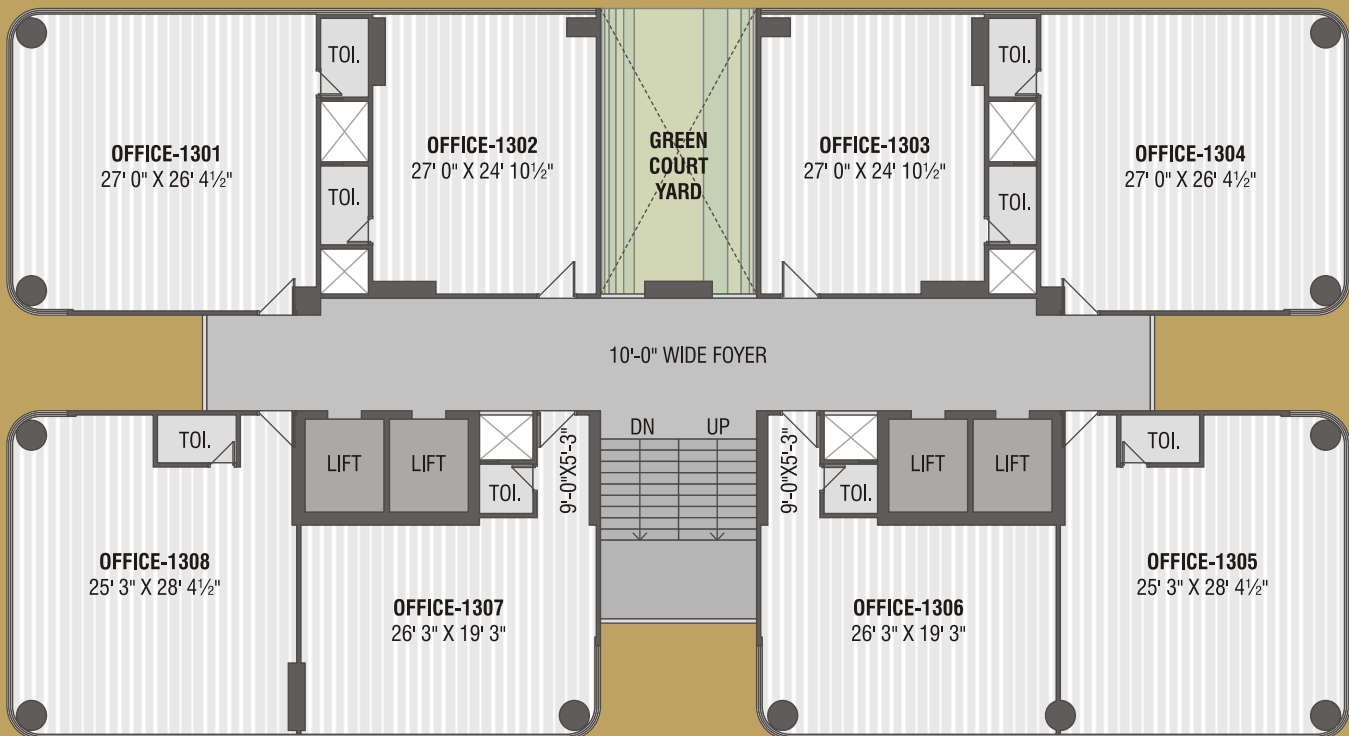

13TH FLOOR PLAN

SPECIFICATION

TAKING DETAILS TO A WHOLE NEW LEVEL

STRUCTURE	Earthquake Resistant Safe RCC Frame Structure.
WINDOWS	Fully Glazed Anodized Aluminum windows.
FLOORING	Premium Vitrified Tiles in Flooring. Stone Flooring In Staircase.
ELECTRICAL	3 Phase 5 KVA Load. Concealed Wiring with MCB.
LAVATORY/PLUMBING DOORS	Vitrified Tiles Flooring with Standard Quality Sanitary ware Internal Doors- Flush Door. Superior Quality C.P. Or S.S. Finish Hardware Fittings.
ELEVATORS	Fully Automatic Premium Quality High Speed Elevator.
WATER PROOFING	Waterproofing in all Lavatory & terrace area to prevent seepage.



LOCATION MAP

TAKING POSITION TO A WHOLE NEW LEVEL

A magnificent workplace. Krish Cubical puts forward a new benchmark for corporate spaces in Ahmedabad. The remarkable design makes it stand apart, while balancing the ambitious and commercial priorities.

This state-of-the-art building offers breathtaking green environs along with avant-garde features. A modern 13-storey marvel with a spectacular entry and all the accompaniments, it certainly is an ideal workplace for companies with grand visions.

