

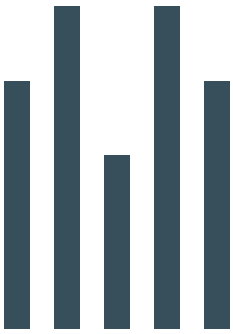

PASSION AT WORK



SOBHA
AVALON
THE URBAN UTOPIA

LIVE ACTIVE

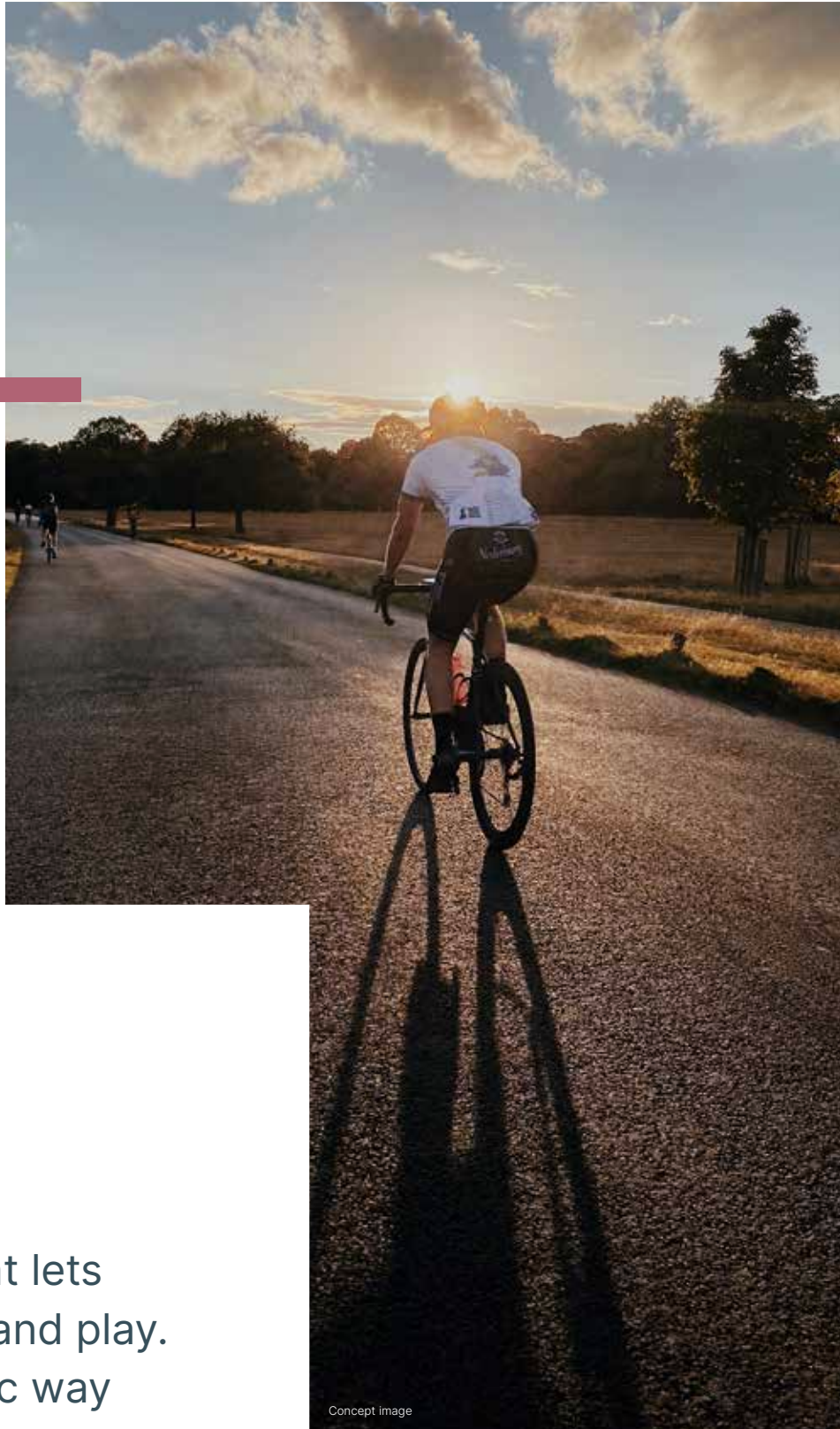

Lead a lifestyle that lets
you balance work and play.
Embrace a dynamic way
to live – one where your
mind remains keen,
and body stays active.

**TOMORROW,
TODAY**



Strategically located in GIFT City – India's first International Financial Services Centre, SOBHA Avalon offers mesmerising views, first-class facilities, modern-day conveniences, and an active lifestyle for the discerning few.

LIMITLESS LIVING

Your sanctuary complements
the go-getter in you.
Come, achieve the impossible,
immerse yourself in our world-class
amenities, and experience the
ultimate in luxury living.



OUTDOOR GYM

Enjoy the splendid views of the outdoors as you attain your daily fitness goals. Spend your time well at the fully-equipped outdoor gym, and experience wellness like never before.

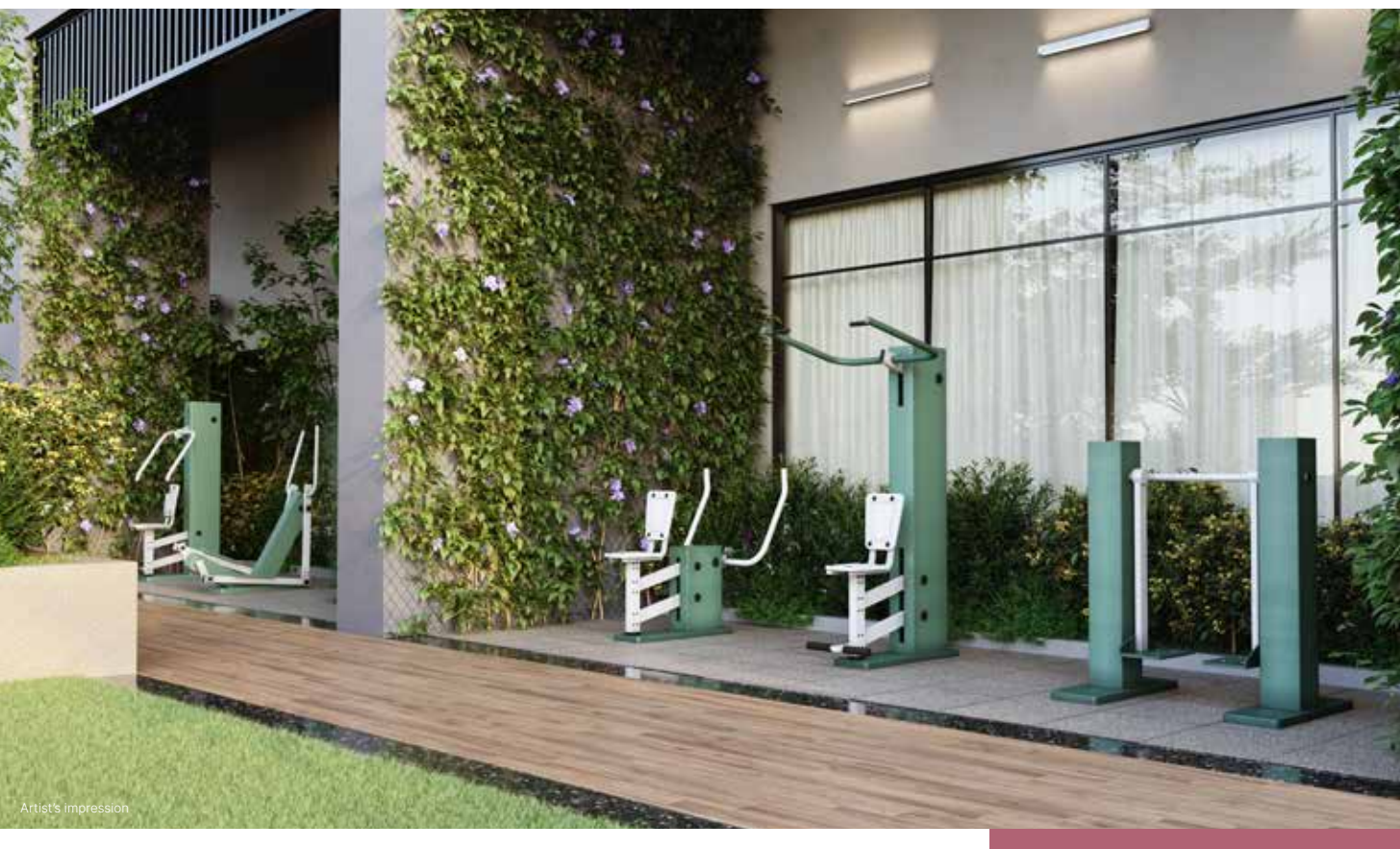

SWIMMING POOL

After working up a sweat at the gym,
take a plunge into the luxurious pool.
Refresh yourself in the soothing waters
and gear up for new challenges.



MEDITATION DECK

Recharge your senses and find tranquillity at the exquisitely designed meditation deck. Whenever you feel like escaping the humdrum of everyday life, this deck is the ultimate place to go to.



Artist's impression

TERRACE LOUNGE



Artist's impression

Set the mood for starlit evenings
and lively lunch parties.
Immerse yourself in an open-air
environment that exudes charm
in abundance.



EVENTS PLAZA

The important days of your life
deserve to be celebrated.

Here's a perfect backdrop for
those jubilant times – adding glitz
and glamour to every Janmashtami,
Navaratri, Uttarayan, Diwali
and much more. Celebrate every
festive occasion and sought-after
events with aplomb.



REFLEXOLOGY WALK

Stimulate your senses,
as you walk barefoot
on the therapeutic surfaces
of this invigorating path.
Walk on and enjoy
a carefree, soothing stroll.

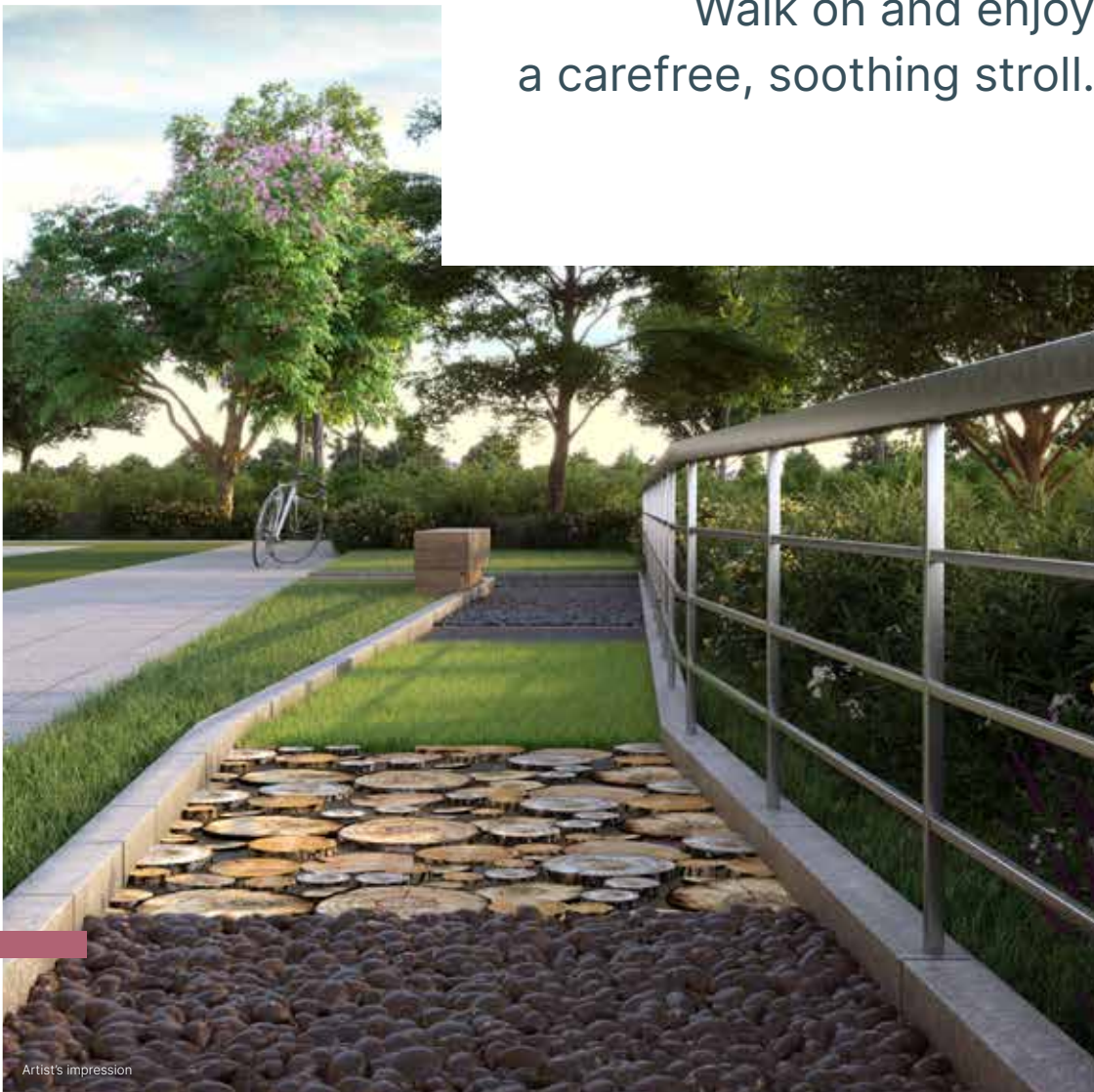

Artist's impression

CLUBHOUSE

Recreation and fitness under one roof! The clubhouse features exclusive amenities, high-class equipment, and a co-working space.



Artist's impression

CO-WORKING SPACE

Experience a seamless work-life balance. This comfy co-working space, just a short walk away, is designed to enhance productivity. Enjoy peace of mind as you take on the day's work.



VIBRANT LIVING ROOM

Feel bright and engage in a state of well-being from the comfort of your sanctuary. A Vaastu-compliant living room seamlessly connects the dining area to the kitchen.



EXQUISITE DINING



Artist's impression

A space designed exclusively for savouring every culinary delight, the dining area is the perfect spot for casual banter and hearty conversations with the whole family. Enjoy meals with panache.

SPACIOUS BEDROOM

Indulge in the beautiful views
of the balcony and bask
in the ample natural light
and airflow of your bedroom.

Meticulously designed
and expansive, it is a quiet
respite after a hard day's work.



ERGONOMIC KITCHEN

The stunning kitchen comes with an attached utility area. The work triangle of the hob-fridge-sink helps you dish out a well-balanced meal that suits your vigorous lifestyle.



ELEGANT BATHROOM

Elegance married with astute craftsmanship. Here's your private space that's thoughtfully designed.

Luxuriate and unwind in comfort to soothe your body, mind, and spirit.

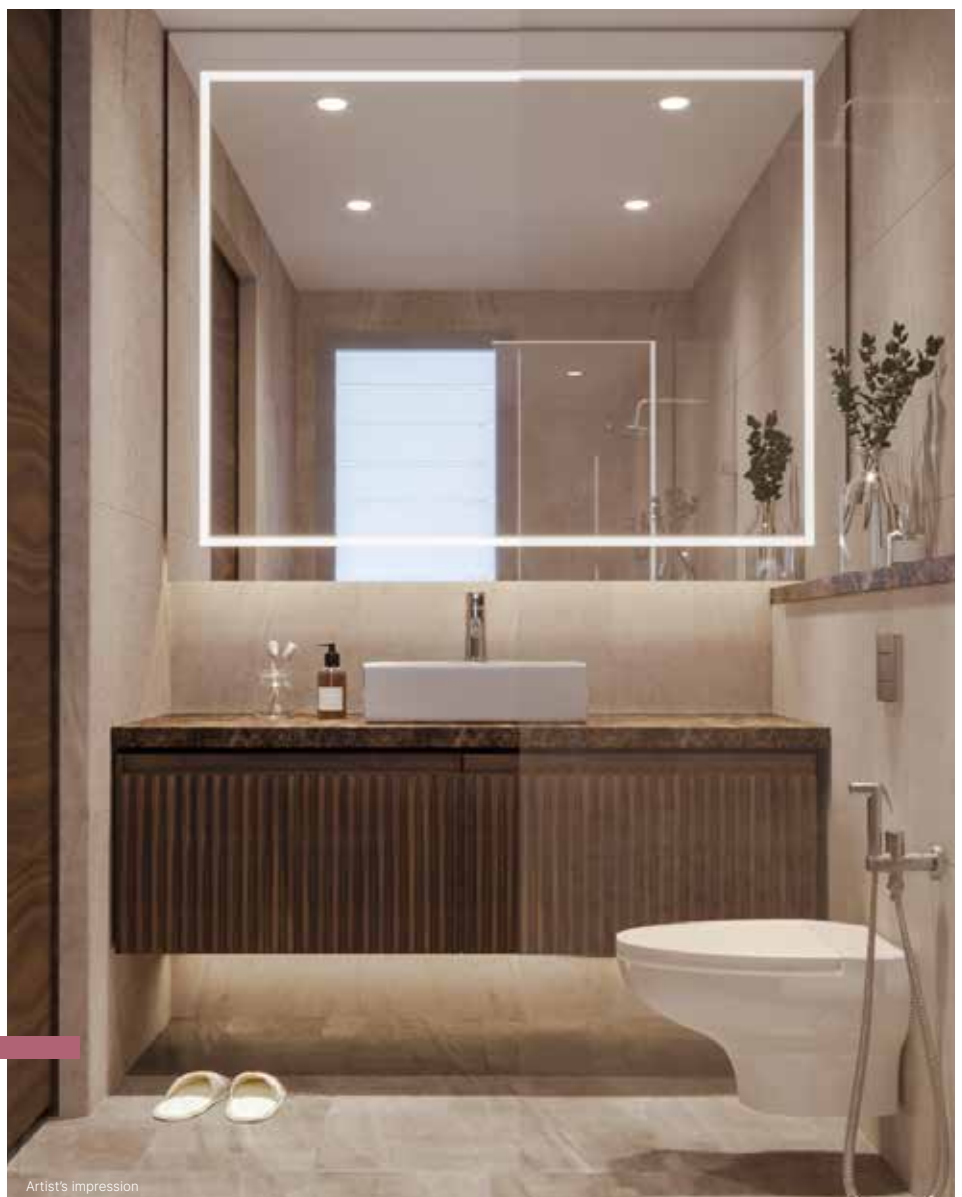

Artist's impression

FUTURISTIC LOCALE

Immerse yourself in an Urban Utopia of eco-friendly infrastructure, futuristic buildings, immaculate green spaces, sparkling water bodies, and a well-connected transport network. Walk on footpaths lined by majestic trees and experience a fine balance between recreational hang-out spaces and residential areas. Embrace a unique lifestyle that goes beyond the dazzling skyline of a global architectural marvel.

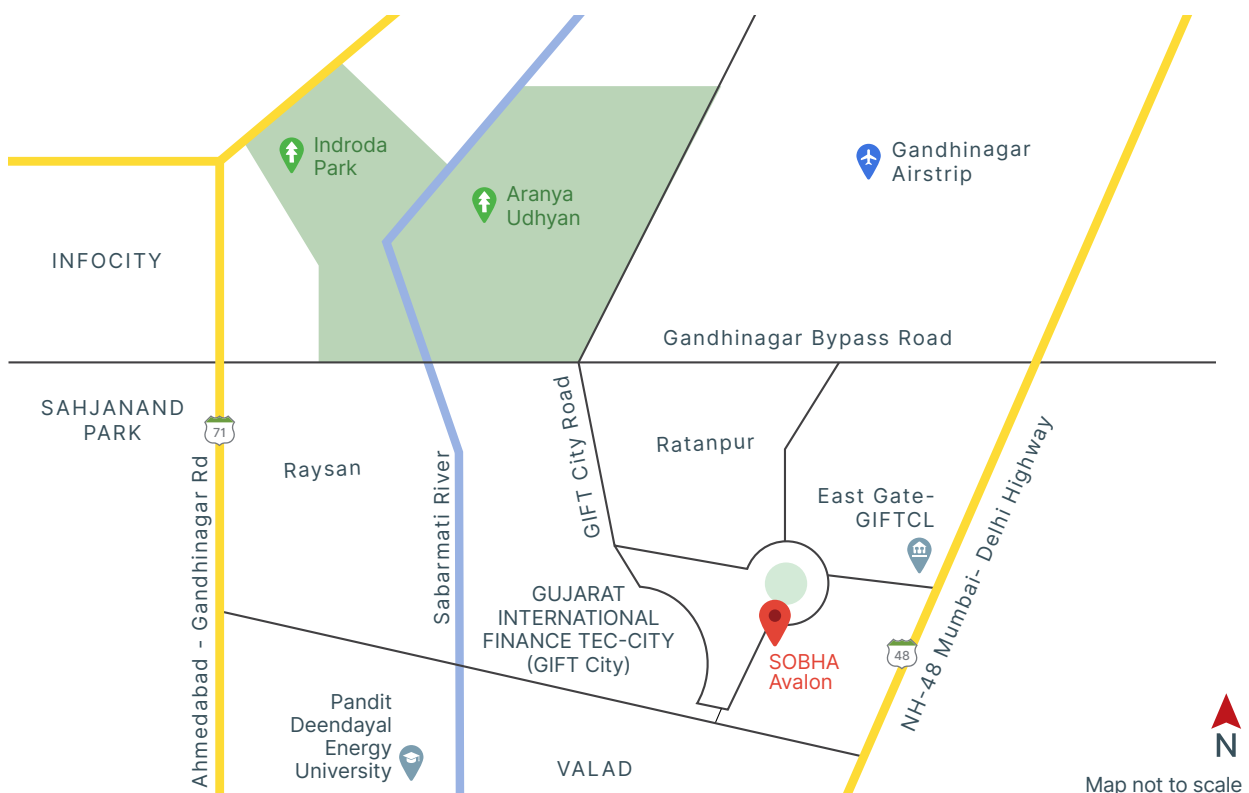

FUTURISTIC LOCAL



MASTER PLAN

1. Entry
2. Reflexology Walk
3. Jogging/Cycling Track
4. Events Plaza
5. Celebration Lawn
6. Pool Plaza & Sun Deck
7. Meditation Lawn
8. Clubhouse
9. Swimming Pool
10. Pedestrian Entry
11. Kids' Play Area
12. Kids' Pool
13. Exit



Site Address: 41C & 41D, Block 41, Zone-04, Shram Marg, GIFT City, Gandhinagar, Gujarat 382355

☎ 080 4646 4500 ✉ marketing@sobha.com

PR/GJ/GANDHINAGAR/GANDHINAGAR/Others/RAA09000/070921 | www.gujrera.gujarat.gov.in

DISCLAIMER: This document is conceptual and not a legal offering by the Company for advertising and is to be used for general information only. Any interested party should verify all the information including designs, plans, specifications, facilities, features, payment schedules, terms of sales, etc. independently with the Company prior to concluding any decision for buying in any of the project. The user of the Brochure confirms that he / she has not solely relied on this information for making any booking / purchase in any project of the Company. The visuals and information contained herein marked as "artistic impression" are artistic impressions being indicative in nature and are for general information purposes only. The visuals contained marked as "generic image" and other visuals / image / photographs are general images and do not have any correlation with the project. The imagery used on the brochures may not represent actuals or may be indicative of style only. Photographs of interiors, surrounding views and location may not represent actuals or may have been digitally enhanced or altered. These photographs may not represent actuals or may be indicative only. Computer generated images, walkthroughs and render images are artist's impressions and are an indicative of the actual designs. No information given on this brochure creates a warranty or expand the scope of any warranty that cannot be disclaimed under the applicable laws. The information on this brochure is presented as general information and no representation or warranty is expressly or impliedly given as to its accuracy. While enough care is taken by the Company to ensure that information in the brochure are up to date, accurate and correct, the readers / users are requested to make an independent enquiry with the Company before relying upon the same. Nothing in the brochure should be misconstrued as advertising, marketing, booking, selling or an offer for sale or invitation to purchase a unit in any project by the Company. The Company is not responsible for the consequences of any action taken by the viewer relying on such material / information in this brochure without independently verifying with the Company.



PASSION AT WORK

FLOOR PLANS

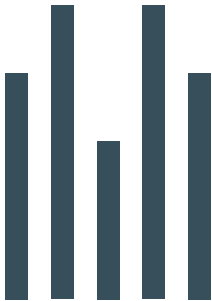

SOBHA
AVALON
THE URBAN UTOPIA

TYPE A

3BHK

SBA - 1749 SFT

CARPET AREA - 1005 SFT

FLOOR PLAN



Key plan

All dimensions in mm

SBA & Carpet Area rounded up to nearest whole number

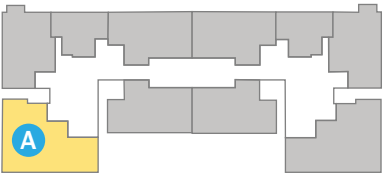
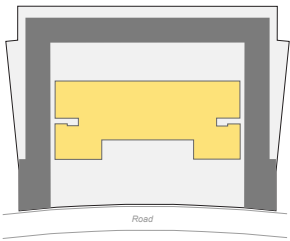

TYPE A1

2BHK

SBA - 1484 SFT

CARPET AREA - 797 SFT

FLOOR PLAN



All dimensions in mm

SBA & Carpet Area rounded up to nearest whole number

Key plan

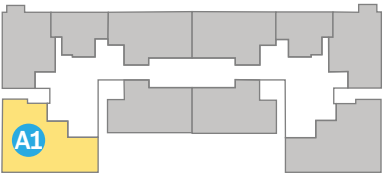
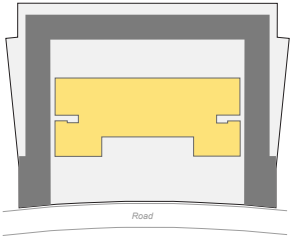

TYPE B

2BHK

SBA - 1304 SFT

CARPET AREA - 743 SFT

FLOOR PLAN



Key plan

All dimensions in mm
SBA & Carpet Area rounded up to nearest whole number

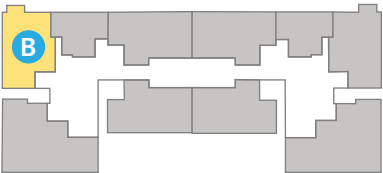
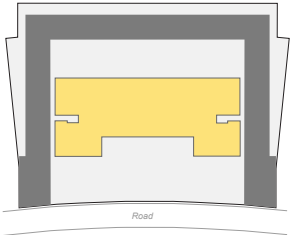

TYPE C

2BHK

SBA - 1307 SFT

CARPET AREA - 731 SFT

FLOOR PLAN



Key plan

All dimensions in mm

SBA & Carpet Area rounded up to nearest whole number



TYPE C1

1.5 BHK

SBA - 952 SFT

CARPET AREA - 516 SFT

FLOOR PLAN



All dimensions in mm
SBA & Carpet Area rounded up to nearest whole number

Key plan

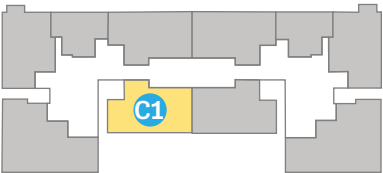
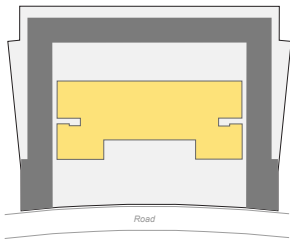

TYPE E

1 BHK

SBA - 736 SFT

CARPET AREA - 405 SFT

FLOOR PLAN



Key plan

All dimensions in mm

SBA & Carpet Area rounded up to nearest whole number

