



**Ranjan
heights**

1 & 2 BHK Premium Homes @ Ravet



"Home is where Love Resides Memories are Created"



**Ranjan
heights**

"Swaraj Construction" proudly present our new housing scheme **Ranjan Heights** at Ravet. Step in to the charming realms of **Ranjan Heights**, designed and finished with Great Quality.

It's a Project of Ten floors residential with 2 level Parking having 1 & 2 BHK Premium Homes. **Ranjan Heights** has close connectivity with IT Park Hinjawadi, Pradhikarn, Educational Institutes, Hospitals and very quick access to BRT road and Mumbai - Pune Express way.

Ranjan Heights is high-yield investment opportunity as well as owing to it's high appreciation.

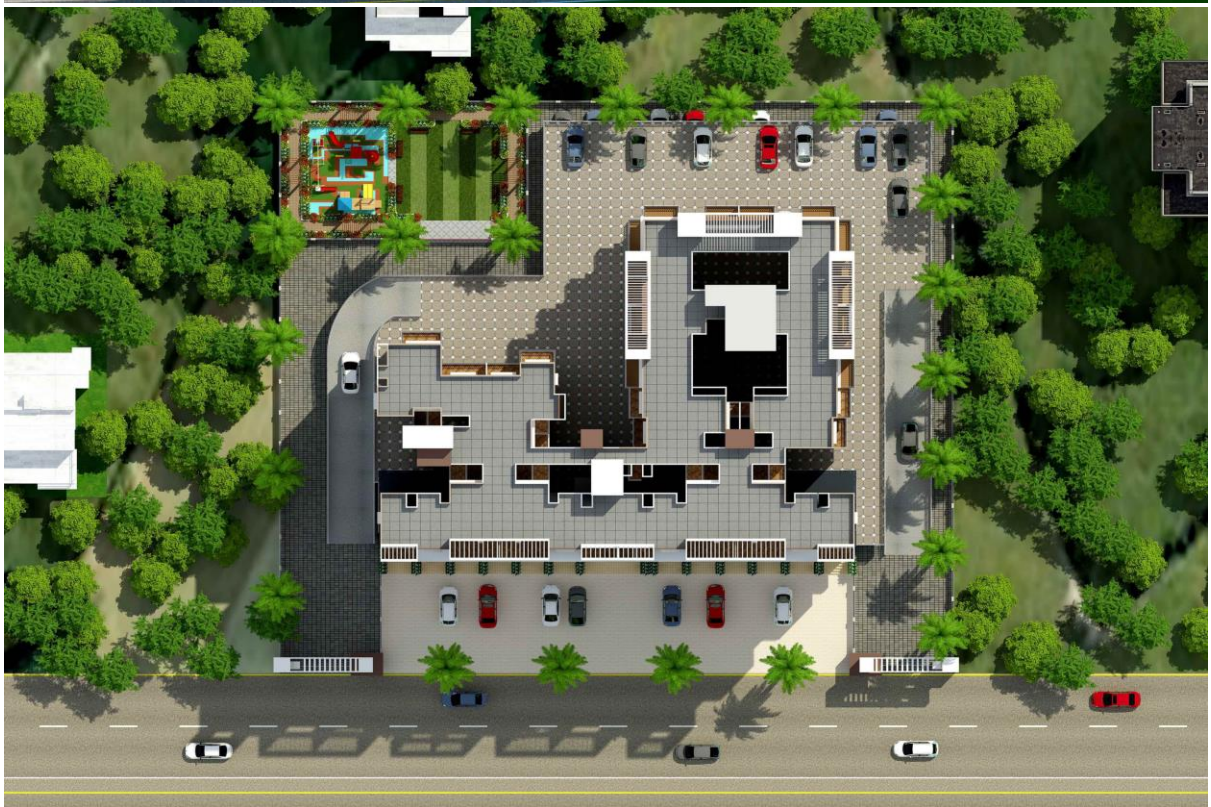





1 bhk



2 bhk

2nd, 4th, 6th & 10th floor Plan



Wing B - Second Floor

Type	Flat No.	Carpet Area (sq. ft.)	Enclosed Balcony	Terrace Area
2 BHK	201	51.77	8.53	6.49
1 BHK	202	38.80	5.36	5.77
1 BHK	203	38.86	4.21	5.23
1 BHK	204	39.27	4.21	5.23
2 BHK	205	55.09	4.97	7.68
2 BHK	206,207	55.09	4.97	9.55
2 BHK	208	47.79	12.16	7.69

Wing B - Fourth, Sixth, Eighth, Tenth Floor

Type	Flat No.	Carpet Area (sq. ft.)	Enclosed Balcony	Terrace Area
2 BHK	401,601,801,1001	51.77	8.53	6.49
1 BHK	402,602,802,1002	38.80	5.36	5.77
1 BHK	403,603,803,1003	38.86	4.21	5.23
1 BHK	404,604,804,1004	39.27	4.21	5.23
2 BHK	405,605,805,1005	55.09	4.97	7.68
2 BHK	406,606,806,1006 407,607,807,1007	55.09	4.97	9.55
2 BHK	408,608,808,1008	47.79	12.16	7.69



Wing B - Third, Fifth, Ninth Floor

Type	Flat No.	Carpet Area (in Sq. M)	Enclosed Balcony	Terrace Area
2 BHK	301, 301, 901	49.35	10.92	7.21
1 BHK	302, 502, 902	41.42	2.72	5.77
1 BHK	303, 503, 903	38.86	4.19	5.17
1 BHK	304, 504, 904	39.27	4.19	5.18

Type	Flat No.	Carpet Area (in Sq. M)	Enclosed Balcony	Terrace Area
2 BHK	305, 505, 905	55.09	4.97	12.14
2 BHK	306, 506, 906, 307, 507, 907	55.09	4.97	9.71
2 BHK	308, 508, 908	51.77	8.27	12.17

Wing B - Seventh Floor

Type	Flat No.	Carpet Area (in Sq. M)	Enclosed Balcony	Terrace Area
2 BHK	701	49.35	10.92	7.21
1 BHK	702	41.42	2.72	5.77
1 BHK	703	38.86	4.19	5.17
	704, 705	REFUSE		
2 BHK	706, 707	55.09	4.97	9.71
2 BHK	708	51.77	8.27	12.17



Specifications

Structure

- Earthquake resistant R.C.C. Structure
- All walls Internal & External in 6" Fly ash brick /red brick.
- Gypsum finished Internal walls.
- Sand faced cement plaster for external walls.
- False ceiling in living room.

Flooring

- 2' x 2' Vitrified tiles in entire flat.
- Anti skid ceramic tiles for toilet & terrace.

Kitchen

- Black granite platform with S.S. Sink.
- Designer dado tiles up to lintel level over Kitchen Platform

Electrification

- Premium quality modular switches.
- Provision of Inverter point for each flat.
- Provision for A.C point in bedrooms.
- Telephone & Television point in master Bedroom & Living room.

Painting

- Internal wall in oil bound paint & external wall is acrylic paint.
- Oil paint for M.S. safety grills & railings.

Bathrooms & Toilet

- Designer dado tiles up to lintel level.
- Granite door frame.
- Waterproof flush door shutters with premium fitting.
- Concealed plumbing with standard C.P. Fitting.
- Premium sanitary fitting with cold & Hot mixing unit.

Doors & Window

- Designer main door.
- Laminated flush door shutters with premium fitting.
- Premium Aluminium sections in powder coated windows with mosquito mesh with safety grills.
- M.S. folding door for terrace.

Amenities

- Grand entrance decorative gate.
- Broadband connectivity provision.
- Rain water harvesting.
- Video Door Phone for each flat.
- Fire fighting system.
- Generator backup for common area & Lift.
- Solar Hot Water system for bathroom.
- Children play area.
- C.C. TV in Parking area.
- Letter Box & Name plate for each flat.
- Garbage Chute.