



MAKE EVERY MOMENT EXTRAORDINARY

- 5 premium towers
- Towers 1 to 4: stilt + 23 storeys
- Tower 5: stilt + 20 storeys
- Floor to floor height: 3 metres
- Exclusive grand entrance
- Spectacular gate
- Wide driveway with cycling zone
- Clubhouse



THE PREMIUM RESIDENTIAL ADDRESS OF HINJAWADI

Sportville in Hinjawadi

- Uniquely planned residential community
- Focuses primarily on sports
- Premium 1, 2, & 3 BHK residences



KOHINOOR GROUP

A Legacy of 37 Years

- Verticals: Residential, Commercial, Warehousing, Serviced Youth Hostels
- Led by a highly experienced management team
- Delivered over 6.5 Million sq.ft.
- Over 3 million sq.ft. under construction
- 6000+ happy families
- Diversified interests in manufacturing, logistics and services



HINJAWADI: HOME TO PUNE'S IT GIANTS

- Neighbouring multinational corporations and business parks
- Surrounded by remarkable education and healthcare
- Flawless road connectivity to Mumbai, Bengaluru and Nashik
- Near shopping malls, movie theatres, and markets



Indoor Games - Carrom, Billiards, Football



Gaming Zone - PlayStation, Xbox



Kids' Zone - Climbing Wall, Hoops, Slackline, Ninja Line, Obstacle Course, Zipline



Pet's Play Zone

INDULGE IN RECREATION AND ENTERTAINMENT

- Indoor Games - Carrom, Billiards, Football
- Gaming Zone - PlayStation, Xbox, Wii
- Kids' Zone - Climbing Wall, Hoops, Slackline, Ninja Line, Obstacle Course, Zipline
- Pet's Play Zone
- Party Lawn
- Lawn Mound with Sculpture

A WORLD OF FITNESS AND WELLNESS

- Sports-centric Landscape Podium
- Well-equipped Indoor Gym with Steam and Sauna
- CrossFit Arena
- Joggers' Track
- Tree Plaza
- Herbal Garden
- Aroma Garden
- Sitting Plaza



Sports-centric Landscape Podium



200-metres Joggers' Track



Tree Plaza



CrossFit Arena



Gym with Steam and Sauna



CLUB
ELEVATE



Welcome to
**CLUB
ELEVATE**
@ SPORTSVILLE
• Dedicated 40,000 sq. ft. area
• 10+ exciting sports, fitness, activities,
and wellness avenues.

SPORTIFY YOUR LIFE!

- Shooting Range
- Tennis Court
- Cricket Nets
- Futsal Arena
- Chess Room
- Badminton Complex
- Table Tennis Room
- Swimming Pool and Kids' Pool
- Bark Room
- Basketball Court (multi-marking court)
- Touch Tennis (multi-marking court)

LANDSCAPE SITE PLAN - STILT LEVEL



OPEN SPACE & CLUBHOUSE AREA



MASTER PLAN



PRECISION IS THE KEY TO PERFECTION

Best Practices Specifications

STRUCTURE

- RCC framed structure with 400mm Reinforcement
- AAC block work walls of 125mm

FLOORING AND TILES

- 600 x 600 mm vitrified tiles for the entire apartment
- Ceramic anti-slip flooring for terraces and balconies
- 800 x 800 mm ceramic wall tiles in kitchen

RAILING

- 100 x 100 glass railing for terrace

WINDOWS & DOORS

- Three-inch insulated aluminum windows with mosquito nets
- H&G grid for living room, bedroom & kitchen windows from inside
- Heavy-duty door with stainless steel
- Bathroom flush door with laminate finish with 600mm
- Washroom flush door with laminate finish with 600mm
- Provision for anti-kick bar in toilet and kitchen
- Digital lock and video door phone for main door of the flat

LIFTS

- Automatic elevators

BATHROOMS

- Concealed plumbing and flush valve
- CP-Fittings, Sanitaryware, Jaquar, Porcelain Tiles
- Hot and cold mixing units in toilet
- Solar-heated water supply in one bathroom
- Trapped water supply for flushing

ELECTRICALS AND CABLES

- Electric wires / Cables / Equipments in tube
- Telephone point in living room and master bedroom
- Sewerage backup for lift and kitchen areas

KITCHEN

- Black granite platform with backsplash board with 100mm of granite / equipment zone
- Height of kitchen doors above platform - 1000mm

PAINTS

- Oppium Primed walls and ceiling
- 2 coats of acrylic premium emulsion paint for exterior walls and ceiling
- External wall with textured paint
- Semi-gloss or matt for gate

SECURITY



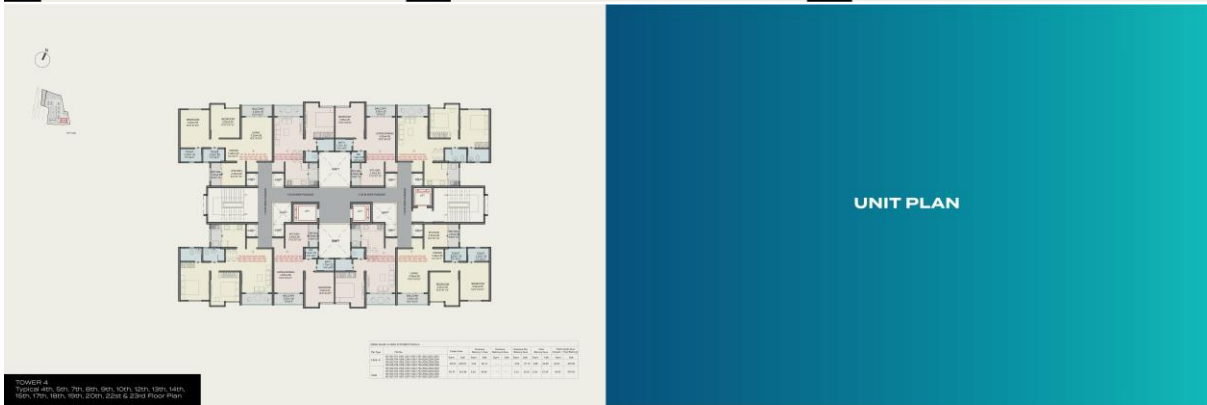

- CCTV for common areas





**5 SOLID PILLARS.
1 LIFETIME PROMISE.**

The diagram features five circular icons arranged horizontally, each representing a pillar. Below each icon is its corresponding label. The background is a solid blue color with a large, faint, stylized 'U' shape behind the text and icons.

- 
Branded Homes
- 
Secure Living
- 
Sustainable Living
- 
Maintenance Team
- 
Healthy Lifestyles