



— RUNAL —  
**GATEWAY**  
**BUNGALOWS**  
PHASE II

MahaRERA Registration No.: P52100019500

and is available on the website <https://maharera.mahaonline.gov.in> under registered projects.

### 3 BHK UNIT PLAN GROUND FLOOR



### FIRST FLOOR

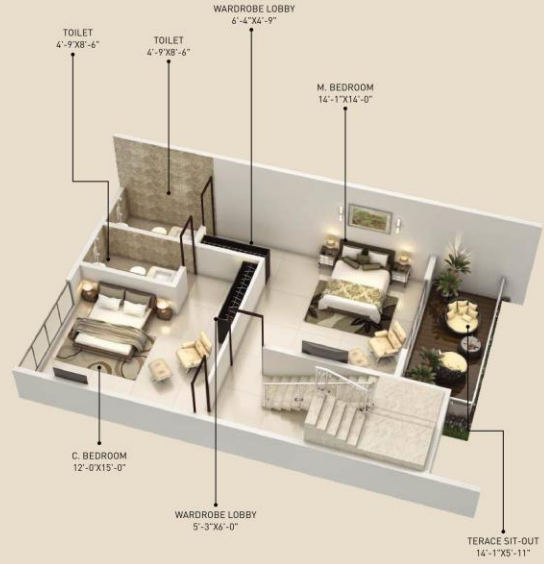

## PROJECT AT A GLANCE

#### A. GENERAL

- Kitchen platform in composite marble/granite by Kalinga or equivalent premium material
- Front door, 7'7" tall and 35 mm. thick both side laminated flush door
- Internal doors, 7'7" tall and 30 mm thick both side laminated flush door with door magnet
- Anodized Aluminium Windows:
  - a) Partly fixed and partly sliding sections, up to lintel level
  - b) mosquito net and granite / marble bottom sills
  - c) 8mm toughened glass for fixed section
  - d) 4mm-6mm thick glass for sliding section

- 32" x 32" double charge vitrified flooring by RAK, Kajaria or equivalent brand
- False ceiling in living, dining, kitchen, washroom
- SS sink in kitchen by Nirali or equivalent brand
- Door locks by Europa or equivalent brand
- Wooden look Anti-skid ceramic tiles in terrace area
- Inlet provision for water purifier
- Cut-out for chimney exhaust and cut out for gas pipe-line (if installed in future)

#### B. WASHROOMS

- C.P. fittings by Grohe or equivalent brand
- Anti-skid flooring with dado tiles by RAK, Kajaria or equivalent brand up to lintel level in toilet and bath
- Sanitary ware by TOTO or equivalent brand
- Wash basin with counter in/attached to each bathroom by Kohler or equivalent brand

#### C. ELECTRICAL

- Modular switches by Legrand/ Schneider/Anchor (Panasonic) or equivalent brand
- Exhaust fan in kitchen and toilet
- Video door phone by Wipro or equivalent brand
- Inverter ready electrification
- Plug point for water purifier, chimney, router
- 3 phase connection for individual apartment



**ON GUARD  
ALWAYS TO  
GUARD YOUR  
LOVED ONES**

24x7 SECURITY &  
CCTV SURVEILLANCE SYSTEM  
AT STRATEGIC POINTS



**PRIVATE SPACE  
NEEDS  
FAR SUPERIOR  
SAFETY**

VIDEO DOOR  
PHONE

Representational Image

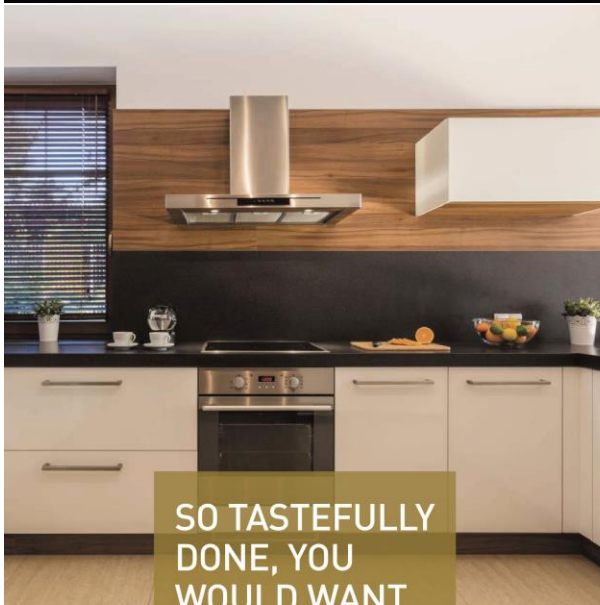

**SO TASTEFULLY  
DONE, YOU  
WOULD WANT  
TO LIVE IT ALL**

SPACIOUS KITCHEN LAYOUT  
WITH SEPARATE UTILITY AREA.



**STAY REFRESHED  
AND STAY  
AT YOUR BEST  
EVERYDAY**

HI-TECH BATH FITTINGS  
& FIXTURES

Representational Image

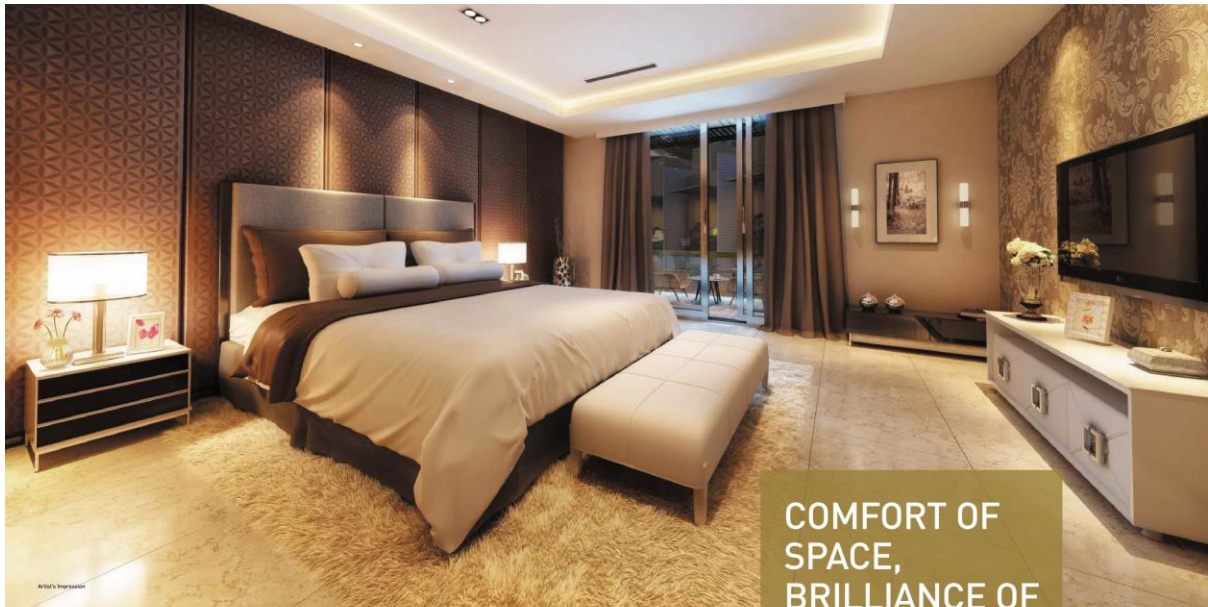

COMFORT OF  
SPACE,  
BRILLIANCE OF  
AMBIENCE

SPACIOUS  
MASTER BEDROOM

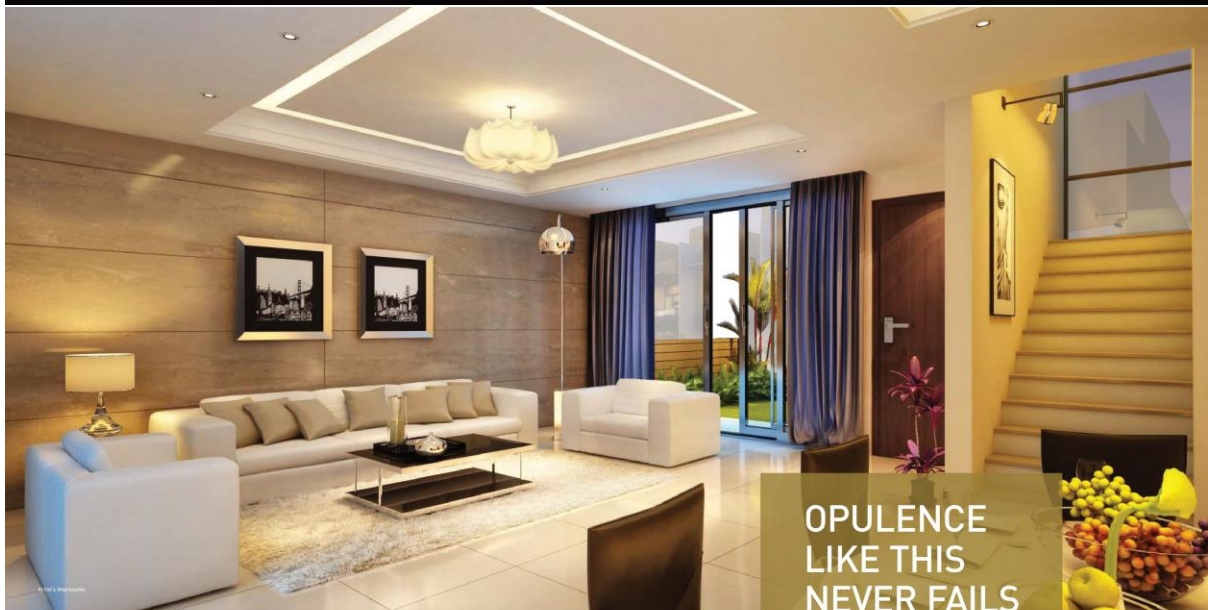

OPULENCE  
LIKE THIS  
NEVER FAILS  
TO IMPRESS

LUXURIOUS  
LIVING & DINING ROOM

BUNGALOW &  
COMMON FEATURES

EXCLUSIVITY IS  
A LUXURY,  
LIVE IT THE  
WAY YOU LIKE



- LUXURIOUS LIVING ROOM
- SPACIOUS MASTER BEDROOMS
- SPACIOUS KITCHEN LAYOUT WITH SEPARATE UTILITY AREA.
- 24X7 SECURITY & CCTV SURVEILLANCE SYSTEM
- VIDEO DOOR PHONE
- PRIVATE PARKING
- PRIVATE GARDEN
- PRIVATE TOP TERRACE
- EXTRA STORAGE SPACE

EXCLUSIVE  
LIVING AMIDST  
REFINED  
EXPERIENCES



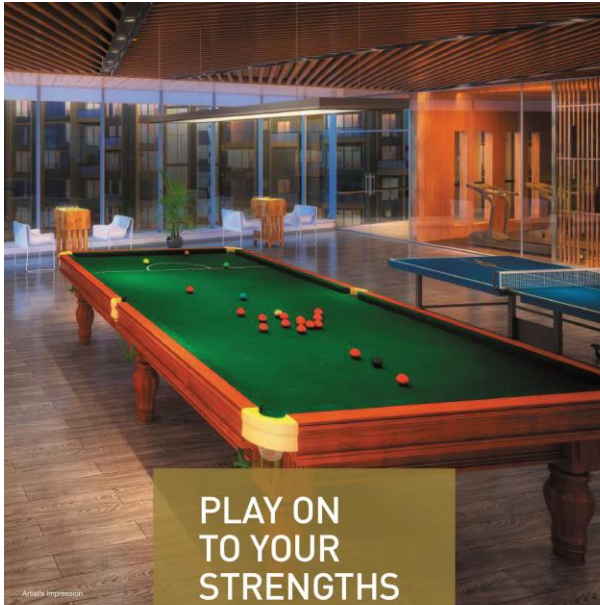

## PLAY ON TO YOUR STRENGTHS AND WIN

INDOOR GAMES ROOM  
(TABLE TENNIS, CARROM  
& SNOOKER)



## DEDICATED TO SMILES, LAUGHTER & CHIRPS

KID'S PLAY AREA



## PLAYING A SPORT TAKES THE SPIRIT TO A NEW LEVEL

TURF COURT

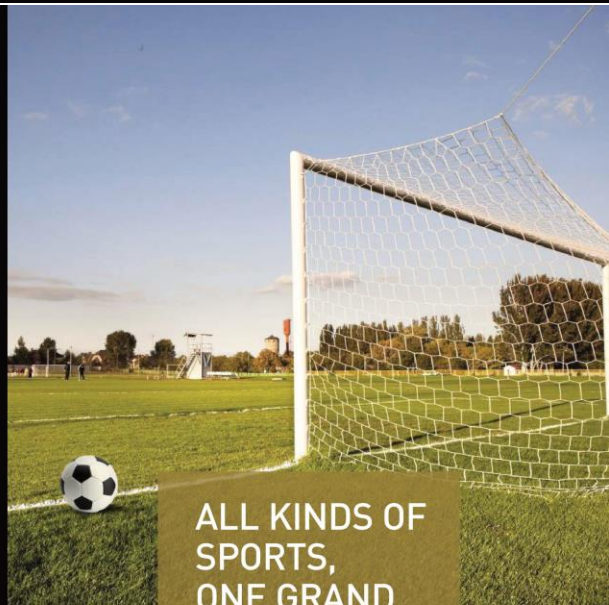

## ALL KINDS OF SPORTS, ONE GRAND CANVAS

MULTIPURPOSE  
GROUND

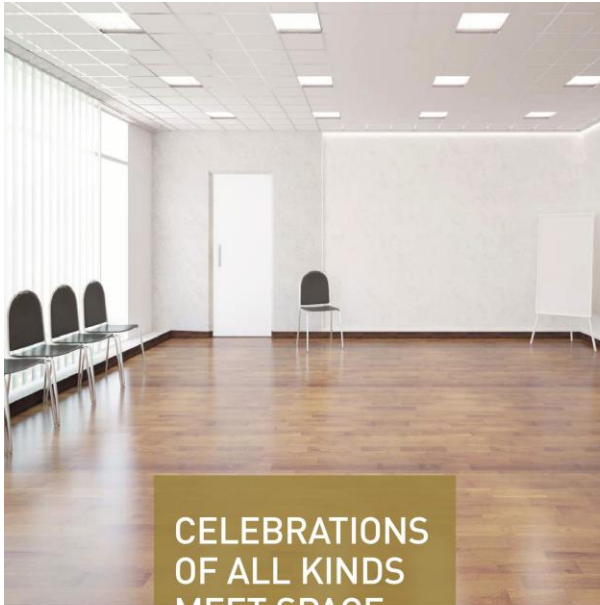

CELEBRATIONS  
OF ALL KINDS  
MEET SPACE  
THAT SUITS ALL

RECREATIONAL HALL



TAKE YOUR  
BEST SHOT TO  
TAKE DOWN  
THE OPPONENT

INDOOR BADMINTON  
COURT

Representational Image

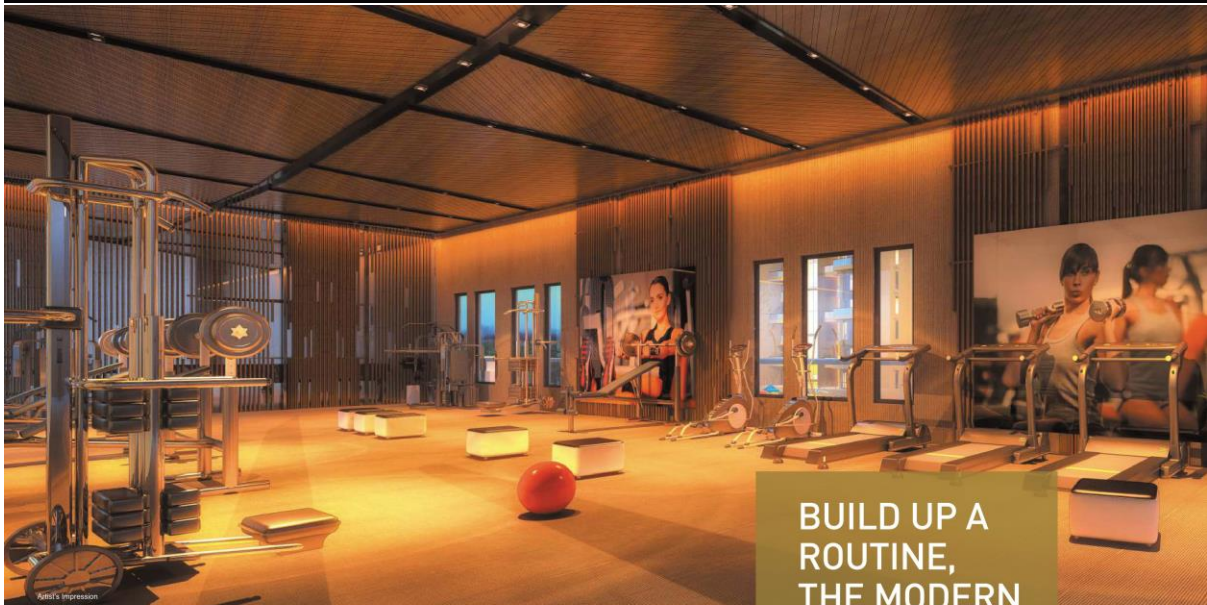

BUILD UP A  
ROUTINE,  
THE MODERN  
WAY

ULTRA-MODERN  
GYMNASIUM

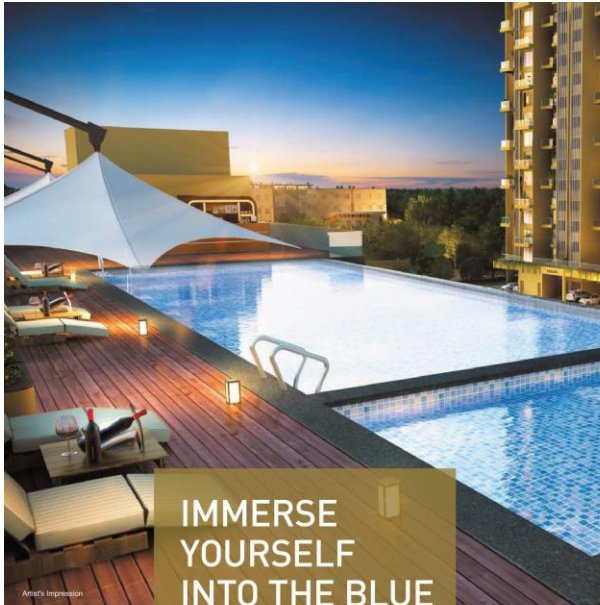

## IMMERSE YOURSELF INTO THE BLUE HAPPINESS

SWIMMING POOL WITH  
KID'S POOL



## ENJOY THE HOT & COLD SIP UNDER THE CAPTIVATING SKY

ROOFTOP  
CAFETERIA

Representational Image

## SPORTS AVENUES & REJUVENATION

## BRINGING EXCITEMENT & VIGOUR CLOSE TO YOUR DAY-TO-DAY LIFE



Representational Image

- KID'S PLAY AREA
- ROOFTOP CAFETERIA
- MODERN GYMNASIUM
- MULTIPURPOSE GROUND
- SWIMMING POOL WITH KIDS POOL
- TURF COURT WITH NATURAL/ARTIFICIAL GRASS
- INDOOR GAMES (TABLE TENNIS, CHESS & CARROM)
- RECREATIONAL HALL CUM INDOOR BADMINTON COURT



EXCLUSIVE LIVING  
SET IN 1.2 ACRES OF  
LIFESTYLE ADDRESS

## THE EMERGING PICTURE OF AN EXCLUSIVE LIFESTYLE

MASTER LAYOUT - PHASE I & II

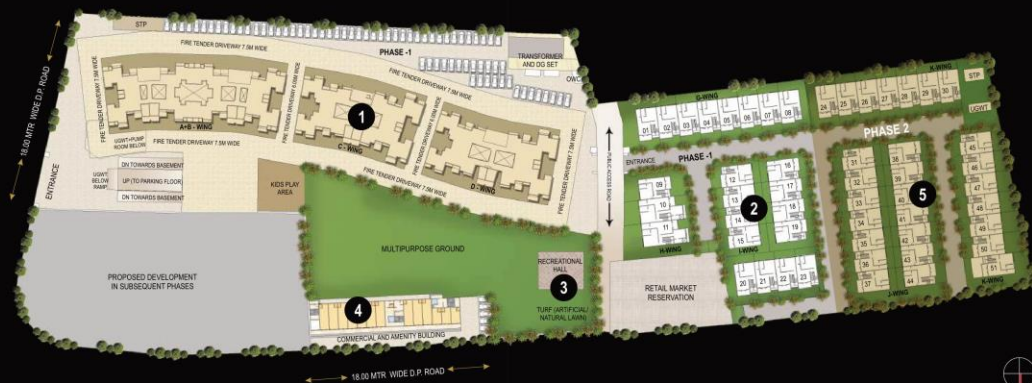

1. A, B, C & D RESIDENTIAL

2. BUNGALOWS PHASE I

3. RECREATIONAL HALL CUM  
INDOOR BADMINTON COURT

4. COMMERCIAL - GROUND + 1st FLOOR  
- CLUBHOUSE & GYM - 2nd FLOOR  
- ROOFTOP CAFETERIA &  
SWIMMING POOL - 3rd FLOOR

5. BUNGALOWS PHASE II

## PCMC, PUNE EXPERIENCE THE LUXURY OF COMMUTING

### Location Standpoints:

- Connected to all arterial roads leading to the city
- Close to Symbolix Skills & Open University
- Near D-mart & major bazaars
- Leading Proposed CBSE school "City Pride" - 2 kms
- Close to Pune International Cricket Centre
- Adjacent to Sentosa Resorts & Water Park
- Aundh-Ravet Bus Terminal Nearby
- Aditya Birla and other Major Hospitals Closeby
- Close to Akurdi Railway Station
- 15 mins drive to Hinjawadi IT Park
- Few minutes from major 5-star Restaurants and Motels
- Pune Airport - 29 kms
- Proposed Navi Mumbai Airport - 102 kms via Expressway



LOCATION MAP

**MUMBAI VIA EXPRESSWAY**  
At Trivijunction of Mumbai Pune Expressway,  
Mumbai-Bangalore Bypass and  
Aundh-Ravet BRTS Road



**PUNE INTERNATIONAL  
CRICKET CENTRE**  
For the undending love  
of the game



**HINJAWADI IT PARK**  
The paradise of  
Techies that symbolises Pune.

Representational image



## EXTRAVAGANCE THAT WELCOMES YOU TO OPULENT LIVING

28 ARCHITECTURALLY SUPERIOR BUNGALOWS  
FOR THE MOST EXQUISITE OWNERSHIP

- 3 BHK PRIVATE RESIDENCES
- 2 STOREY EXCLUSIVE FRONTAGE
- HIGH DESIGN GLASS WINDOWS
- PRIVATE GARDENING SPACE
- PRIVATE TOP TERRACE
- EXTRA STORAGE SPACE
- ISOLATED CLUSTER FOR PEACE  
WITH LANDSCAPED AREAS
- PRIVATE CAR PARK

# EXCLUSIVE BUNGALOW LIVING

IN THE GATEWAY TO  
A NEW LIFE



RUNAL  
GATEWAY  
BUNGALOWS  
PHASE II



YOUR  
EXCLUSIVE  
FEELING  
OF A HOME CLOSE  
TO THE HEART

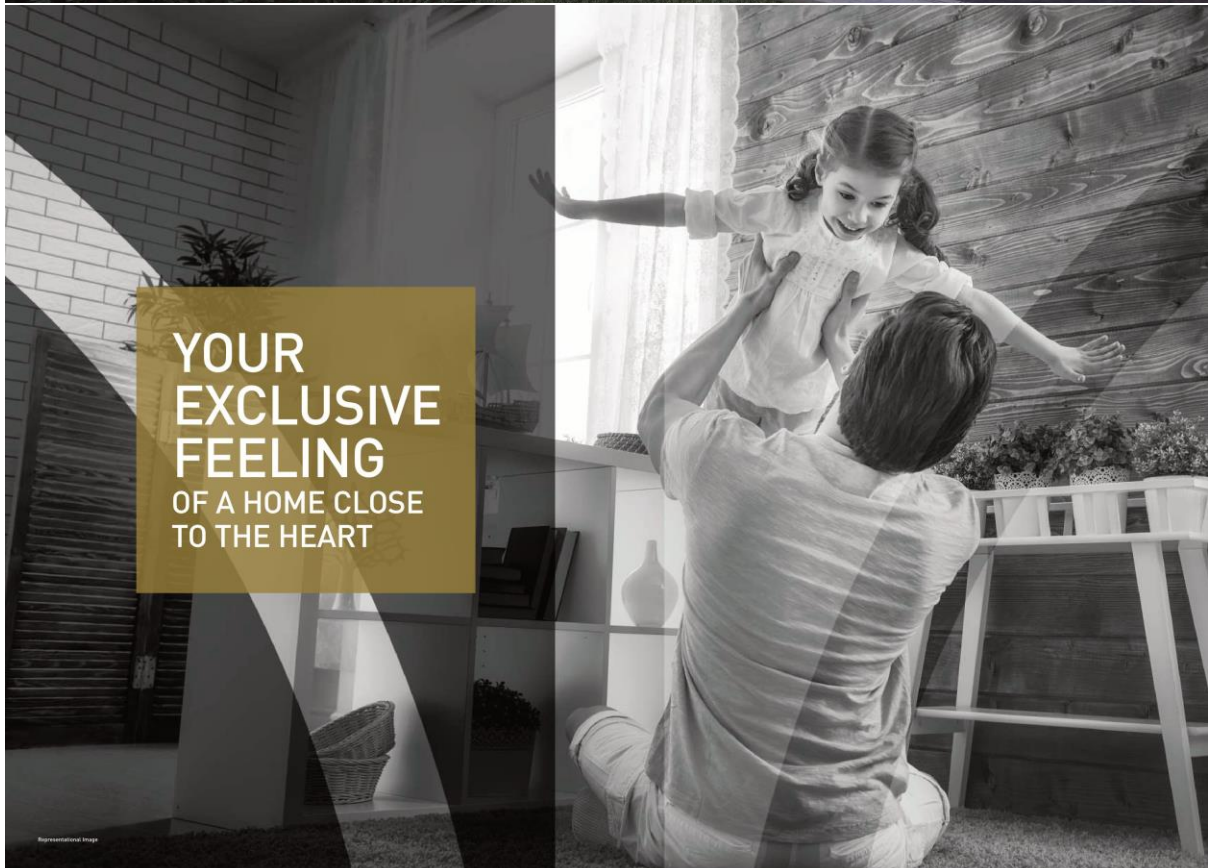

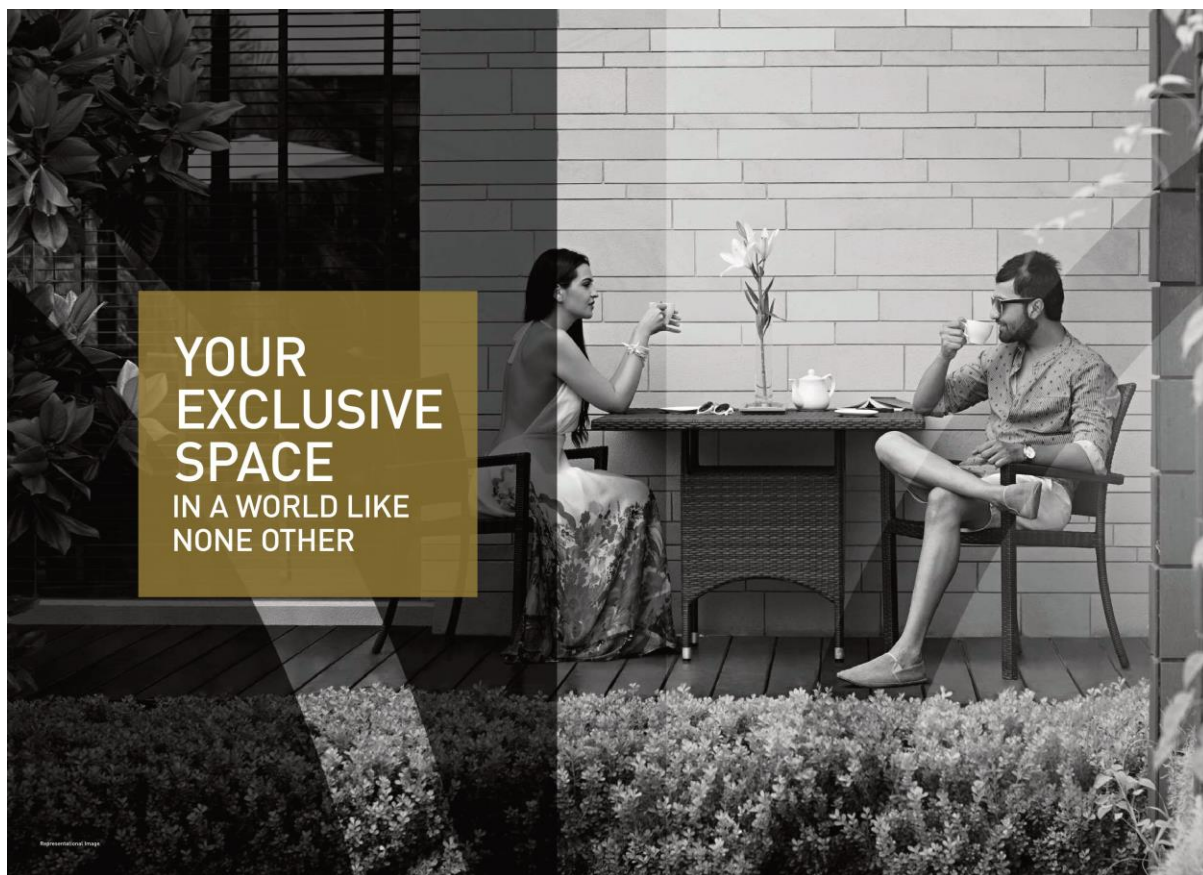

**YOUR  
EXCLUSIVE  
SPACE**  
IN A WORLD LIKE  
NONE OTHER



**YOUR  
EXCLUSIVE  
ADDRESS**  
OF EXTRAORDINARY  
EXPERIENCES



A company and a growing brand that is not a real estate company, but a progressive idea fused with trust, reliability and passion as the building blocks. Founded in 1993, the company has been carving a niche for itself through consistent delivery of quality and value. A testimony to this is the overwhelming response that the company has received from its customers over the decades. Today, the company has developed more than 24 projects, and aims at forming an illustrious skyline in the coming years with a new passion and new enthusiasm that celebrates the factor of 'You' in each landmark it creates.



Representation Image

## THE MARK OF FUTURE, BENCHMARKS OF THE NEW ERA



Runal Elanza

Runal Royal Casa

Runal Deepmala

### RUNAL'S PROJECT TIMELINE



IN MORE THAN TWO DECADES, WE HAVE SHAPED A MULTITUDE OF  
LIFESTYLE ADDRESSES ACROSS THE PUNE CITYSCAPE

TOTAL DEVELOPMENT, OVER A  
MILLION SQ. FT.

MANY SUCCESSFULLY  
DELIVERED PROJECTS



TIMES REALTY ICONS AWARD FOR BEST AFFORDABLE PROJECT IN  
PCMC GIVEN TO RUNAL'S ROYAL CASA